

the PYRAMID Guide

NO. 15

Jan-Feb
1975

Bi-monthly *International Newsletter* Vol. III, No. 3

Single Copy 75¢ Yearly Pre-Paid \$4.50 Foreign \$5.50

WHEN PYRAMID TESTS FAIL

by V.L.C.

There's something more at work here than a form and presumed magnetic force(s). The pyramid and other form energies are likely the highest, finest vibrations manifesting on our planet. These vibes or waves of form like radio signals are already there. The pyramid or similar hollow geometric shapes, acting as accumulator-generators of these fields stores the power for ready use.

We have but to turn our radio on and select the station or frequency of our choice. Our antennas collect the radio or TV waves transmitted. It is the added power source of the radio or television receiving set that pulls in and amplifies the signal thus connecting it to sound and/or picture.

I mentioned before that we should look beyond magnetism for the total source of pyramid energy. Since magnetism, electricity, electromagnetism and gravity are more easily measured, and we apply these earthly forces mostly in the advancement of our technology, it is only logical our technicians first developed these energies.

Most open-minded scientists I've consulted agree it's entirely possible that pure pyramid energy may cover a whole range of vibrations each having their own band. These higher, finer rays, etheric in nature, operate high in the fields above x-rays and gamma rays. Vibrations combine to produce wave forms manifesting as phenomena, effects with an unmeasurable cause, though these forces harmoniously interpenetrate and blend with our commonly recognized earth and sky energies. Still,

Continued on page 4

A MEMORIAL TO GEORGIANA, THE SUDDEN DEPARTURE OF A BEAUTIFUL BEING

This issue is dedicated to the memory of Georgiana Teeple, our beloved co-editor, publisher, who wishes to be remembered for the joy she knew in the creation and publication of the PYRAMID GUIDE.

Georgiana transcended our earth plane September 13, 1974. I find no logical way of grouping words to express the great personal loss of Georgiana's vivacious, loving presence. The magnitude of her selfless service to humanity as a Divine creature of God is her legacy. We will continue to see and feel the results of Georgiana's remarkably organized thought, and the life she breathed into this newsletter. Her column PYRAMIDIA won high recognition.

In reflecting on Georgiana's passing I now realize the need for the 'GUIDE'S' perpetuity, conceived by us in conversation three years ago. It serves a call beyond anything we had ever imagined, a constant surprise and splendid learning experience for us both.

Georgiana agonized over the awesome and rapid deterioration of our planetary conditions, man's destruction of nature and evidenced, diminishing human values. These were big judgements for her, as Georgiana always looked for the best in everyone, and in all things. She was an outstanding teacher of unique talents, demonstrated by gentle action more than with words. Georgiana's ever-flowing love consciousness drew to her in return, qualities and quantities of love beyond expected mortal bounds.

It has been said there are Angels who walk amongst us, "Be not forgetful to entertain strangers for thereby some have entertained Angels unaware." Hebrews 13.2 Many among her friends agree, Georgiana may well have been a

Domestic \$4.50
Foreign \$5.50

All Current Single
and Back Issues
@ 75c each



messenger from the Angelic kingdom. It has been an extreme pleasure to have lived within the orbit of this most gifted writer, artist and mystical teacher.

Despite the seeming separation imposed by Georgiana's departure, her Spiritual and earthly vibrations remain as an inspiration in our time, enroute, on-path, toward our ultimate awareness and oneness in the eternal Cosmic All.

Bill Cox

THE GREAT INVOCATION

FROM THE POINT OF LIGHT WITHIN
THE MIND OF GOD
LET LIGHT STREAM FORTH
INTO THE MINDS OF MEN.
LET LIGHT DESCEND ON EARTH.

FROM THE POINT OF LOVE WITHIN
THE HEART OF GOD
LET LOVE STREAM FORTH
INTO THE HEARTS OF MEN.
MAY CHRIST RETURN TO EARTH.

FROM THE CENTRE WHERE
THE WILL OF GOD IS KNOWN
LET PURPOSE GUIDE
THE LITTLE WILLS OF MEN —
THE PURPOSE WHICH
THE MASTER KNOWS AND SERVES.

FROM THE CENTRE
WHICH WE CALL THE RACE OF MEN
LET THE PLAN OF LOVE
AND LIGHT WORK OUT
AND MAY IT SEAL
THE DOOR WHERE EVIL DWELLS.

LET LIGHT AND LOVE AND POWER
RESTORE THE PLAN ON EARTH.

DOMES, SPHERES AND SOLIDS

By Marianne Zezelic

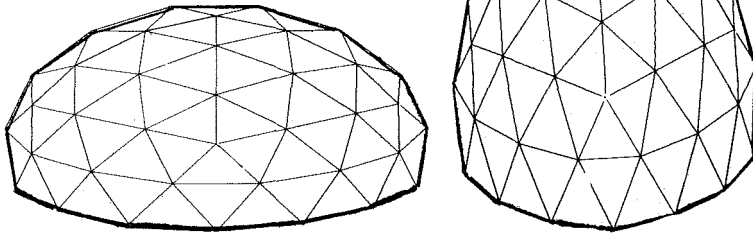

From the Appalachians to the Rocky Mountains, from the Great Lakes to the bayou country, domes in various sizes have sprung up in profusion. Communes, colleges and high school projects have tinkered with the simple, versatile shape of the sphere with low cost housing in mind. By duplicating and improving spherical structures by primitive societies, one moves away from static-structure rectangular grids into the world of symmetry and natural design.

Domes evoke unseen psychic and psychological tides of the universe which affect levels of the subconscious mind. These tides operate through the magnetic sphere of the earth and underlie the physical forces of electricity, magnetism, light and heat. Geometric shapes also produce a cumulative suggestion process upon the subconscious mind. This suggestion process speaks to the subconscious mind of man through the archaic images of its symbols, thereby producing "changes in consciousness."

There exists in the subconscious certain levels of development, and the deeper of these levels link the individual not only with the minds of his immediate neighbors, but successively with the mental processes of all mankind down to a certain level, and below that again with the consciousness of the animal and vegetable kingdoms. In terms of evolutionary development the subconscious mind is older than the conscious mind, and it retains one trait of its immemorial past in that it works by images, not words. Each of the five physical senses reporting to the brain sends in a series of images visual, tactile, audible, subconscious mind with their appropriate emotions. If, therefore, one consciously introduces carefully selected images into the subconscious mind one can evoke the corresponding emotion. Since the emotions are the subjective aspects of the driving energy which wells up from the deeper levels of the mind, it is evident that by the right use of such conscious evocation the potential of the personality can be greatly enhanced.

Domes, spheres and solids provide such an avenue of approach. By building domes and spheres, man has unconsciously tapped into knowledge known by the ancients, the knowledge that we have access to forces and energies beyond our normal understanding, if we will but open the doors in the right way.

The Well Shall Never Dry Up . . . Thank you, Thank you, Thank you, Dear Readers for the many unsolicited, interesting and valuable contributions to THE PYRAMID GUIDE.

THE PYRAMID GUIDE

An international bi-monthly newsletter issued Jan., March, May, July, Sept., and Nov. Annual Subscription rate \$4.50. Foreign by surface mail \$5.50. Edited and published by Bill Cox and Georgiana Teeple of EL CARISO PUBLICATIONS, 13680 MONTE VISTA ROAD, LAKE ELSINORE, CALIFORNIA

The Pyramid Guide welcomes letters and briefly-written articles dealing with form and free energy; pyramids, pyramidology, geometric shapes, energy accumulator-generators, psychokinesis, levitation, bioenergetics, psychotronic, physical, mental, metaphysical, psychic, and higher forms of energy; emanations from thought-forms and precious stones; vibrations from color and other waves of form — including dowsing and high expressions of soul and "psi."

Opinions expressed by contributing writers do not necessarily reflect those of the editorial staff and publishers of the Pyramid Guide and El Cariso Publications.

Copyright © 1974 by El Cariso Publications, printed in the United States of America. All rights reserved. No part of this letter may be used or reproduced without written permission of El Cariso Publications.

Application to mail at second-class postage rates is pending at Lake Elsinore, California 92330.

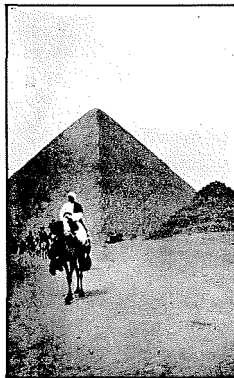

CHEOPS

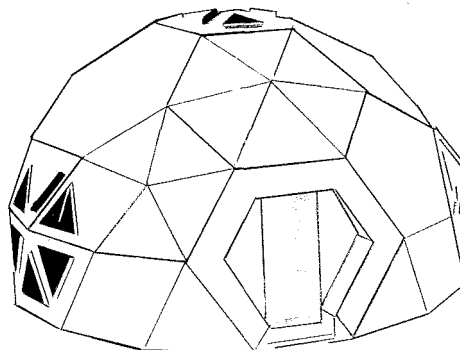

BUCKY FULLER'S
HEXA-PENT DOME

We should look deep into what constitutes magic and non-magic, for we see a strange mixing of magician and psychic upon the platforms of demonstration today. Who among us will rise to delineate precise lines dividing the puny pond of hocus pocus from the so-called sea of psychic experience, another kind of magic? The boundaries separating contrived abracadabra and high magic — the realm of the miraculous — can only be determined from within. The mind directs all activity, even if the approach is different. By contrast, the eastern student seeks to express matter by an inward-upward search for union with Spirit, while western man attempts to create by manifesting Spirit down through matter. In magic, we may well witness or experience a subtle coalescence of both, each technique passing the other going by.

But be ready to change your reaction after beholding the works of a mage, for what appears as supernatural may suddenly be exposed as sheer trickery. Presumed fakery, on the other hand, may surprisingly hold up as the real thing. Retractions from skeptical scientists not readily forthcoming, are occasionally deserved.

The entertaining magician-mentalists who is always right — unless he chooses to be wrong for laughs, or to achieve a certain effect — sometimes finds himself fine-tuned into his subject well beyond the ordinary, calculated performance. He touches the unknowable and it unfolds as high magic.

The shaman, in his approach to physical conjuration, sleight-of-hand, mechanical, light, magnetic and chemical props may involuntarily assume powers outside the range of his intellect. Still, you will hear magicians scoff at the suggestion they are psychic or practicing mediumship. The imaginative performer continually dwells on the twilight borders of ultra-awareness and psychic sensitivity.

More than not, sincere psychics with subdued egos readily admit to their limitations; they are doing well if they're right sixty or 70% of the time. There are too many variables.

The clairvoyant gathers information in symbolic form, imagery, frequently in fragmented form. He moves forward and back in non-time dimensions and attempts to equate his impressions with the rigid demands of our clock-time world. The information channeled through is usually correct, but wrongly interpreted, results in a misreading. Data is one thing, evaluation is another.

Conversely, the stage magician works within known parameters. He's comfortable with his art in a cleverly evolved routine. Should he fumble, the pseudo magi need only practice a little harder at home to get his act together. The polished magician can charm the birds out of the trees when his cloak has emptied of pigeons. A little hoodoo goes a long way and the magician is on safe ground; he doesn't claim supernatural powers. From another point of view, the psychic or medium gradually sensing the loss of his powers may turn to hocus pocus. Some who have achieved unexplainable phenomena unfortunately turned to trickery. When detected pulling a psychic ripoff, their previous demonstrations were quickly written off by disbelievers. Those who believed, or wanted to believe, could only throw their hands up in despair. Had they been taken in by their champion? Eusapia Paladino, an extraordinarily gifted medium fell into this trap several years ago.

Light centers may be doing the psychic a disservice by scheduling magicians and mentalists on their programs without making a clear distinction between the two ranges of human expression. Combining the two under one classification requires an expertise of immense proportions.



TEEPÉE TIME. Dennis Brock of East

Highlands, Calif., reports: "A friend of mine lives in a teepee: a conical structure. There is a very nice feeling inside."

PYRAMID CHURCH. The Houston, Tex., Unity Church of Christianity was constructed of "baked golden aluminum material" and not anodized aluminum as reported in a previous issue of the Pyramid Guide. Houston psychics reportedly detect the most pyramid energy when a pyramid is oriented about ten degrees to the East of Magnetic North.

LEAD FOIL CAPSTAN. A. J. Geiger of Columbus, Ohio, writes: "Here's an idea you might check out: Put on a pyramid a lead foil capstan WITH NO PUNCTURE IN THE APEX and extending about two inches downward on each side. Set the pyramid on a lead foil base. Does the amount of energy concentration in the pyramid increase? It should, since there will be no escape of energy upward out of the apex or downward out of the base."

GARDEN PYRAMIDS. Rev. Bessie Havens of Phoenix, Ariz., says: "Am working with several (pyramids) made of coat hangers in my garden and the results are great. Also have one to sharpen razor blades ...and it works..."

BLACKLIGHT. Since certain insects are irresistibly drawn to flame and light sources, a commercial insect control device now produces true blacklight, multiplying many times over the usual attraction expected. The invisible light rays, considered harmless to humans, pets, wildlife and environment, reportedly reach maximum efficiency during nighttime hours, a Robot Pied Piper of sorts. By contrast, one wonders if some form of whitelight could not be used to drive bothersome insects away without killing them?

ONE BILLION DOLLAR PLUS PYRAMID. Richard S. Pepper, a Chicago area contractor estimates cost of reproducing the Great Pyramid of Giza would be approximately \$1.1 billion these days.



"The answers I'm looking for," Cameron vows with unflinching eyes, "are confirmed by the unity of the aurameter, my super-conscious or my Angel, Peter Autrines."

"Your Angel . . .?"

"Yes. I found my Neanes* quite by accident," he went on . . . "Fourteen years ago I was alone in my room experimenting with the aurameter. Suddenly I felt the overwhelming presence of some unseen force. In questioning my instrument I found unmistakable proof of Peter Autrine's presence—and by polarizing the aurameter with my own body magnetism the Angel was able to match his own energy to mine. Peter said he was my guardian and was there to help me."

"How did you get along without your Angel before 1954?" I asked.

"I used my highly-developed super-conscious," he said, scratching his temple. "I once thought dowsing was a natural mechanical phenomenon, but now I know it is a thing of the mind—mental and physical."

With Peter's help, Cameron says, he only uses geological knowledge to prove-up what he has already found with the aurameter.

CAMERON says he first discovered the magic of the forked twig when his grandmother showed him how to divine for water on his Escondido homestead in 1925. Born in Sioux City, Iowa, the son of a Scottish minister-newspaperman and a mother of German descent, Verne Cameron became an inventor in his youth. In his maturity he was a master machinist, shop superintendent, and machine designer.

"I have a trace of Cherokee Indian blood. It has given me a trailing instinct," he says with pride.

Continuing Series

A DOWSER AND HIS ANGEL — A sketch of the late dowsing mentor, Verne L. Cameron, of Lake Elsinore.

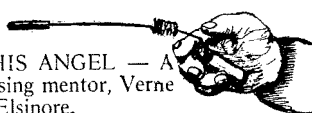

**"NEANES":

According to Cameron, in the Angelical language, means "Guardian."

Cameron also shows traces of his father's leanings, having written articles for various international publications dealing with psychic phenomena and dowsing.

In 1952 he was ordained a minister in the Spiritualist Church, but now rejects commercial spiritualism. "I'll find my own personal paths to truth," he says in a voice ringing with melodic overtone.

Cameron makes no claim to special powers of extra-sensory perception: "I've merely developed a force all human beings have." He goes on further to say that those born with a caul (veil) have a mysterious second sight . . . "and I readily admit it's a gift I've never had."

"Strange things can happen," Cameron claims. "Some people are born with reverse polarity. When this happens, the divining rod will invariably turn inward to them."

Cameron says his "feeling for water" comes through faith. "You have to believe," he declares, "or you'll never divine water."

When asked about his failures, Cameron quickly replies: "I've located over five thousand water wells, and a number of good oil deposits in my forty-two years of locating." And he says with emphasis, "Using my Angel's help, I guarantee ninety-five percent satisfaction. Oh! I get a kick every now and then. . . . Sometimes a client runs out of money and doesn't finish the job—or he'll get cold feet and follow someone else's advice. This is disastrous! Sometimes it's an equipment breakdown."

"Then you admit to a one-in-twenty chance of failure?"

"Yes. I'm only human. . . . Things can go wrong. . . ."

Cameron acknowledges the dangers of overconcentration: "It's possible to visualize a temporary thought picture of an underground stream that doesn't exist." And he adds with rising brow, "The sub-conscious plays tricks on you."

He abhors the term "witch." "I'm a professional Water Locator," he says.

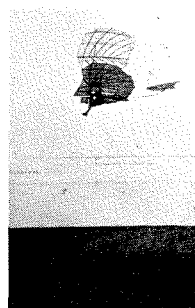
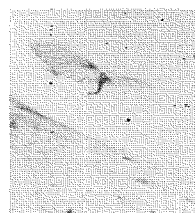
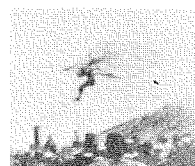

Sky-Surfers . . .
Hang-Glider
Freaks . . . Look!
La Fin d' Un
Planement d'
Otto Lilienthal
He Did It In 1896



SUBSCRIPTION ORDER FORM

- ☐ The Pyramid Guide, bi-monthly, International Newsletter . . . Single Copies 75c each
☐ New or Renewal subscription, yearly prepaid \$4.50. Foreign by Surface Mail \$5.50.

Mail Postpaid to:
Street or P.O.
City & State
Zip

ORDER FROM:
EL CARISO PUBLICATIONS
P.O. Box 176
Elsinore, CA 92530

REFLECTIONS FROM THE THIRD INTERNATIONAL FESTIVAL OF ESOTERIC SCIENCES AND YOGA (TORONTO, CANADA - JULY, 1974)

PSYCHIC ARCHEOLOGY

We saw an astonishing demonstration of Psychometry (picking up the vibrations and history of a held object) by the gentle, psychically aware Irene Rucinski, of the Michigan Metaphysical Society. Irene was one of five panelists moderated by Pat Murphy, Toronto television commentator, all exploring the potential of Mind Regression, (Psychometry).

Dr. J. Norman Emerson, an open-minded archeologist from Toronto, placed a recently excavated old coin in the hands of Mrs. Rucinski, asking for inner impressions she might receive from the object. While Mrs. Rucinski meditated upon the coin. Dr. Emerson explained how he was led to the site of an old foundation by a psychic he referred to only as "George".

The archeologist noted how some ancient archeological locations were "very upsetting" to George, lending some credence to the notion "the older, the colder". Possibly explained as a dissipation of Psychic Vibration through time, in George's case, someone suggested, it may have been a reaction tied to a post-life affinity with old substances projected into his present lifetime frame. However, the information brought through George convinced Dr. Emerson that Psychic Archeology presents exciting opportunities and time-saving explorations at selected diggings.

Irene Rucinski, whether intended or not, used a sophisticated "Systems" approach, logically and cosmologically, running first one series, then another. In this way she brought to conscious awareness, site location, environment, climate, point in time, sound, motion, soil, colors, textures, depths, numbers of, type, dress and race of individuals, also groups associated with the coin and its surroundings and even the interaction of emotions of those closely connected with the site's archeological history.

Dr. Emerson later verified so many of Mrs. Rucinski's incredible observations based on documentation in his hands. Panel members and audience sat in astonished silence throughout the woman's unstaged, impromptu performance.

PYRAMIDS & ALTERED STATES OF CONSCIOUSNESS

By Marianne Zezelic

People who have been inside the Great Pyramid of Giza or scale replicas have reported experiencing varieties of emotions ranging from euphoria to the supersensual. Visions are had, energy fields are sensed and healing potential is recognized, leading one to speculate that something within the pyramid design is inducing an altered state of consciousness and biological changes.

Evidence has proven that the pyramid is an accumulator of energy of an unknown type. It is possible then that a person entering its field undergoes an alteration of their energy field, which brings into focus unknown or forgotten modes of perception. With the speeding up of the body's vibratory frequency (I suspect this is what the body undergoes when inside a pyramid), telepathy and ESP are manifested. Vision is enhanced and the eye responds to the ultraviolet region of the spectrum. This means that the retina of the human eye becomes sensitive to electromagnetic waves that have a frequency higher than 7.5×10^{14} cycles per second. Normally, the human eye is sensitive to electromagnetic waves with frequencies between 4.3×10^{14} vibrations per second.

The world takes on a new perspective when consciousness or vision is altered. Depth perception of our three dimensional world remain unchanged, but one can now see pulsing fields of colored light surrounding objects. Is this the aura or odic force that mediums claim to see? Is this what Kirlian photography captures onto film?

WHEN PYRAMID TESTS FAIL

Continued From page 1.

pyramid power is not definable as solely magnetic, electric or electromagnetic. What of solar energies, light and gravitational forces?

The big splash about pyramid orientation, and specimen alignment—at the one-third King's Chamber level, on a N.S. axis is extremely limiting. We're saying in this test the results are mostly—if not all—dependent on magnetism. But we find experiments with flatter, steeper or misaligned pyramids, made of ordinary substances produce mummification, dehydration, sharpening effects, etc. . . . Even substitute form, and odd shapes of unlikely materials often produce similar effects.

On the other hand, we get regular reports (but in small number by comparison) of beautifully staged pyramids, free-energy experiments winding up a complete bust. The more scientific the test, it seems, the more the strong physical or material approach. Doubting minds, and heavy demands for repeatable experiments psychically interferes with the test. Thus failures increase. So there's something else more than physical action involved here . . .

PREPARE newsletter. Aids to Preparedness — Strategy for Survival

Subscription Info. Box 1889
Seattle, Wash. 98101

PYRAMID AND MAGNETISM NONSENSE, NO! NO SENSE, YES!

Page 4

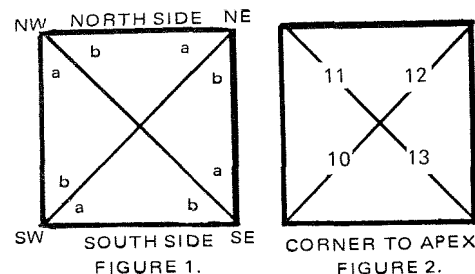

PANEL-LESS PYRAMIDS ABOVE. BOTH TOP VIEW.

While not conclusive, preliminary tests made with a magnetic field analyzer on a 20" base-side, panel-less pyramid by Bill Kerrell of Los Angeles defies rational explanation. A local electronics technician double-checking Bill's findings just shook his head, muttering . . . "this can't be . . ."

Briefly here's what Bill encountered:

Running the inside base rails corner-to-corner, (fig. 1), the gauge alternated between plus and minus gauss. (a) in the inside southeast corner showed the highest reading. Lowest indication appeared at (b) sw corner.

Then running his gauge upward from the base corner to apex, (total hip length approximately 25" O, the higher he went, the greater the response. Hot spots loomed at high (10) figure 2 and (13). Lowest indication appeared near the bottom at (10). Again Bill observed fluctuating readings while moving up from one corner as follows:

Measuring upward from the sw corner outside	1 1/2"
5 1/2" up from the sw corner outside	.4
10" up from the sw corner outside	.0
13" up from the sw corner outside	.3
15 1/2" up from the sw corner outside	.0
17 1/2" up from the sw corner outside	-.3
20" up from the sw corner outside	.0
24" up from the sw corner outside	+.4
Apex	.3
Going up from the sw corner inside	-.1
6" up from the sw corner inside	-.3
10" up from the sw corner inside	.0
13" up from the sw corner inside	+.4
16" up from the sw corner inside	.0
17" up from the sw corner inside	-.1
19" up from the sw corner inside	.0
22" up from the sw corner inside	+.4
Apex	+.3

The above comparisons were determined by maximum or radical change in magnetic responses during the experiment. Scott Moyer of Stroudsburg, PA. Reports: "A magnet placed and oriented inside the pyramid replica seems to increase the power, strength and distance of its energy field, while also establishing definite laws of polarity.



PYRAMID PICNIC SHELTER — Marie Dixon Recreation Director at Belvedere Park in East Los Angeles adds dimension to unique geometric structure — one of several — designed by local architect, Fernando Juarez. The multi-level park and edifices present a striking display to motorists driving along the adjacent Pomona Freeway.



THE COLOSSI OF MEMNON AT THEBES

Dear Bill,

About L. Turenne and Andre Bovis, I knew them both. Turenne died about 1950, Bovis around 1932, or earlier. I was in touch with him but cannot in any way remember him being interested in pyramids. Our local authority was a man called Spink. I published a lot of his stuff in the Pendulum. Bovis was a bicycle maker who took up radiesthesia by accident. His wife destroyed all papers when he died.
Edgerton Sykes, Brighton, Eng.

Dear Friends,

... I don't know if anyone has commented on the energy a person receives from a correctly oriented scale model of the Cheops pyramid placed under the bed. A sleeping person receives small but constant charges of energy, allowing one to need less sleep. Perhaps it is imagination on my part, but I have tried this out for the past two months and definitely believe this to be so.

Margarita Velasco, Mexico, D.F.

Dear Georgiana,

The feature on John Campbell in Pyramid Guide #7 concludes, "It has been said that magic (i.e. wisdom), isn't dependent on matter, but rather on form or pattern.... If this is the case, furthermore, and the answer to Larry Kleeberg be correct (#8. 'Guide Replies), i.e. "...the Dowser's belief IN THE EFFECIENCY OF HIS OR HER DOWSING MACHINE IS PARAMOUNT," then we are confronted with the implication that material objects are only a focus for our mental capabilities, and that everything machines or objects reveal might also be revealed through concentration. Perhaps dowsing devices are similar to LSD -- they activate or speed up variables within a vibratory frequency more readily perceived by the user. But Leary said LSD should be used to bring the user beyond the need for it. The question is, can dowsing and dowsing devices bring one to a stage of awareness beyond the need for them? Can the instrument bring us to experience and knowledge which increase our perceptions permanently?

Bob Freedman, Honolulu, Hawaii

Dear Bill,

I've been getting excellent results on "degree" readings with my Biometer (p.4, Pyramid Guide #6.). My accuracy on the potency of various herbs has been uncanny. Exact degree readings seem to be very easy. Instead of using a tape or rule for numerical divisions, I've been using an electronic hand calculator. The calculator taught me a lot about math and I thought a lit-up readout would make a strong and definite symbol. The aurameter has to be the best thing I ever owned. The other day I was frantically trying to find something in the house. After a half hour of cooling off I picked up the aurameter and within ten minutes it pointed to the lost item. In an experiment of charging one particular book in the bookcase, the aurameter centered in on a group of four books, one of which was the book chosen. I'm sure I will become more accurate with my dowsing with more practice. I have come to realize that psychic energy manifests itself in man to be wasted or developed. I also know this force is readily employed with success in dowsing. During the brief time we talked in Canada your influence helped me to put together things and fine tune into the psychic world and new age.

Scott Moyer, Marshalls Creek, Penn.

Dear Bill,

I fell ice skating and split my head open, one and one-half inches long. Did not go to the doctor. Only used pyramid. All pain left in five minutes. No headaches or pain. I healed in three days. Slept with pyramid lying on my head.

Bob Lawrence, South Euclid, Ohio

Dear Mr. Cox,

...Am sure the information received from my superconscious would be more precisely interpreted if I were using your's and Mr. Cameron's "Aurameter." Especially since I have by-passed much extra work and evaluation by instructing my superconscious to detach from my body, investigate and report back with the information I'm seeking in a most direct fashion. Success has been most accurate, (about 99.7%), except for depths, especially for underground water. I've been operating on the islands of Honduras and mainland for the last five years. Depth has posed problems for me, but I'm convinced my interpretation of information received is at fault, therefore the need for a more sensitive device, tool or extension of myself is necessary. The Aurameter may be that tool.

Keith Deveraux, Islas de La Bahia, Honduras, C.A.

Greetings:

...As you can see from our letterhead, we are part of GWB, and we have a six-foot high pyramid in our church which we use for healing and other things, and are very much impressed with what we have heard of you and your publication. Sincerely in oneness,

Dr. Nele Palmer, Oneness - AUM Temple, Inc. St. Petersburg, Fla.

Dear Sir:

...You may be interested in the field of Chiopractic. You mentioned a single cell in the spinal column could respond through the bio-feedback system in twenty minutes in one of your taped interviews...The efferent half of normal complete cycle 1. Universal intelligence not only does everything in the universe, but also controls each living unit through an innate intelligence, plans (mental), and in accordance with that plan assembles (creation), those units of force with the brain cell/central cell, where this force is transformed into a mental impulse. . 2. The mental impulse is propelled over the efferent nerve going the entire distance to the tissue cell where it is received and there put into material form (physical personification), completed as an expression. 3. The sum of all expression in an organ or part is called the function. 4. The total of all functions of the body give rise to bodily health/harmony, called coordination. I'll write to you about the afferent half later. Dr. H. Magara, D.C. Los Angeles, Calif.

THE 'GUIDE REPLIES ...

From Dawn Ramma, Tonasket, Washington.

Q. We are a group of devoted people about to construct a pyramid on a mountain in the Okanagan country of Washington. We will be using the pyramid as a place of meditation and expansion, following with the energy. We plan to have it as our home until we get other cabins built....Could you give us some suggestions as to what might be detrimental to the energy flow. The dimensions will be 31.41' and the height 20 feet. We plan to build it out of pine logs. Would a loft be detrimental? or inside walls? How about doors and windows/ Does it need any kind of polarity? Does the base have to be on the ground? In other words, can we have it up on poles and fill in a rock foundation so the structure will be about two feet off the ground. Would this be ok for the energy?

A. The loft shouldn't be detrimental, it will however alter the movement of energies inside. The most alive spot in your pyramid will be just below -- and above-- the apex, and the shaft, or line of force running from the center of the floor, up through the capstone peak. Removal of panels doesn't disapeate the energy, but orifices in panels can alter the energy patterns inside with no appreciable difference in the actual "feel" inside. Thus, windows and doors pose no extra problems. The pyramid issues about 20% of its thrust below the base when suspended above the earth or a solid platform, so an elevated model will still perform well, (see #9 issue of the Pyramid Guide). The rock foundation should work out ok, as long as you construct your pyramid with the correct angles and dimensions.

Q. What effect does placing the replica inside a Faraday Cage have on its energies? It seems to me a small replica should be easy to run out inasmuch as a copper window screening could be used to form the cage. The cage, as I understand it, is used to "shield" off suspected emanations and radiations of an unknown quality with persons having powers of telepathy. E.T.W. Mess

A. We believe the Faraday Cage will shield out some energies. There are however a multiplicity of forces and rays emanating from pyramid replicas. Some of these are vibrating high in the spectrum above Gamma rays, according to Verne Cameron. Thus it's quite possible these energies are not altered or stopped by lower vibrating material substances. In other words, a simple pyramid form can accumulate and generate lower octaves of vibration, perhaps speed them up, change their frequency and amplitude, and send them scooting or spinning in free motion unimpeded by any material barrier. We're all stumbling around for answers. To be sure, dousing offers some plausible solutions because these energies can be felt with a cooperating psyche and patient work.

Q. Can you give us the address of the Homeotronic Research Foundation mentioned in your June, 1974 edition of the 'Guide? R.C.

A. Latest word reveals Henry M. Gross of 2905 North Front St. Harrisburg, Pa. 17110 as its president. The foundation, though now somewhat inactive, is interested in carrying on with their work when funds and agricultural scientists become available to them

Q. I find sitting and facing in different directions inside my meditation pyramid results in varied reactions. How about it?

A. The Rev. Robert Short, of the Blue Rose Ministry, in Joshua Tree, Calif. has channeled through this information: ...If the individual wishes to be in composure, then face south. For an increase in energy, face north. If the individual wants to balance or neutralize the vehicle (body), then be seated facing east or west...hold within the form of the vehicle a carbon rod, held with the left hand, which may be extracted from a large dry or wet cell battery, and that which is a copy of what you term "A SYMBOL OF ETERNAL LIFE" or anciently known as the ANKH, also known as the CRUX ANSATA, which means to be tied to the sphere of activity forever. The individual holding it outward, thus is receiving the energy, and conducting this energy back into the earth. If held upward, it is conducting energy outward into the earth's atmosphere. With the rod held in the left hand, and the ANKH in the right one can contain the energy field within oneself. Then hold the area of the chest. Thus a closed circuit is formed with the ANKH cross across the chest, and the carbon rod held across the other area of the chest. This is a symbolism of the FLAIL CROOK. One symbolizing a rod of power. One symbolizing the shepherd of people....

Q. Will you be doing any writing on pyramid replicas and color? Beryl Adams, Toronto, Canada.

A. Yes. In upcoming editions of the newsletter we will be covering extensive research dealing with color, sound and fragrance as it relates to pyramid models, and the unusual properties found in semi-precious stones charged by the replica. The part-scale of cosmic vibrations and illustrated forms indicating the chakras as they relate to color, sound and the elements present an interesting study below. Anyone interested in this subject should hold on to this information as it will simplify future references to the subject. There are differences of opinion but we subscribe to the teachings of Peter Rendel, an English student and master of the eastern approach to higher awareness. His color sequence tied to the chakras correspond beautifully with the natural order of the color spectrum in the upward ascent from red at the low end to violet at the crown.

PART-SCALE OF COSMIC VIBRATIONS (Per Second)

62nd OctaveUnknown
61st> OctaveX-Rays
58th	
57th> OctavePerfumes
51st	(Fragrance)
50th OctaveChemical Rays
49th OctaveLight
	(Physical Color)
48th> OctaveHeat
46th	
45th> OctaveUnknown
40th	
35th> OctaveElectricity
25th	
15th>Physical Sound
4th	

THE HUMAN PYRAMID

WE HAVE ENCOUNTERED SOME REMARKABLE PARALLELS BETWEEN THE PYRAMID AND HUMAN FORM. NOTE THE LOCATIONS OF THE SEVEN MAJOR CHAKRAS, THEIR CORRESPONDING NUMBER, ELEMENT, CHARACTERISTIC, COLOR AND SOUND. MORE ON THIS IN NEXT EDITION.

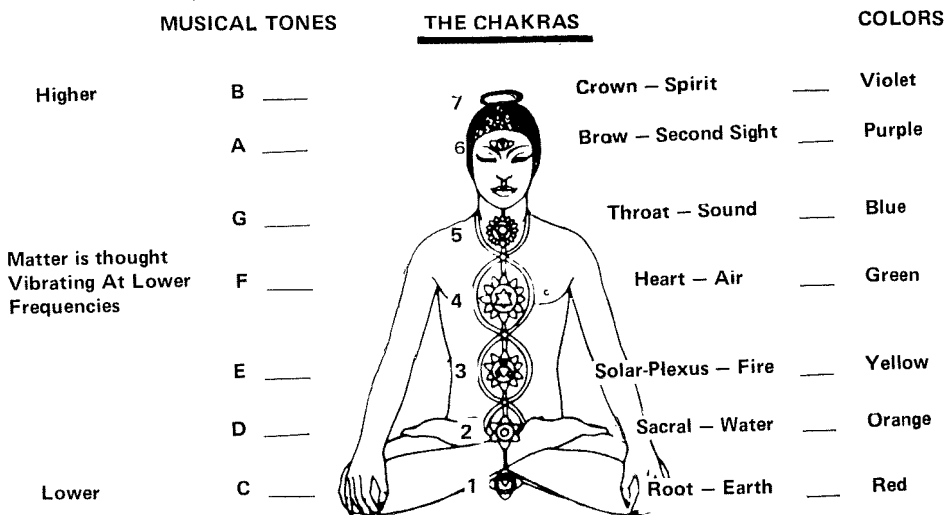

THE 'GUIDE RECOMMENDS . . . SWING RODS

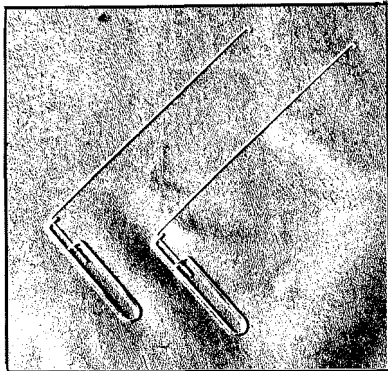

SWING RODS nickel-plated, high precision, non-friction dowsing rods. For the utmost in sensitivity balance and dowsing response as underground water and gas pipe, electrical and conduit locators. These instruments far surpass ordinary "L" rods made from clothesline and clotheshanger wire, welding rod and similar metallic materials usually overgripped and improperly held by dowsing buffs. \$5.50 per pair, add 50¢ for postage and handling. c/o The Pyramid Guide



"How to Survive The Coming Depression". 80,000 vital words \$3.95. Also, data on 100 MPG Carburetors — suppressed Invas — Defense — Hydroponics — Unique Energies — Health — Occult etc. List for stamp. Fry's, 879 — E. Park, Perris, CA. 92370

Interested in E.S.P.???

-then you will enjoy the E.S.P. ORBIT a monthly newspaper on Metaphysics, Psychics, Parapsychology, Magic and the Occult for the open minded seeker - including more & more coverage of where its at locally in many parts of the country. Sample copy 45 cents or one yr. subscription \$5.00 E.S.P. Orbit Inc. P.O. Box 223 Lancaster, Pa. 17604.

MAP DOWSING HANDBOOK

Verne L. Cameron's Mini-Masterpiece he shows YOU how to locate at a distance. Proven methods developed over 46 years as a full-time locator. \$2.75 % The Pyramid Guide, Box 176, Elsinore, CA. 92330.

 LIFE FORCE KEY pendant, ancient 5000 year old symbol of wisdom (gold finish with 24" necklace chain, \$5.95) Once worn by Pythagoras, Thales, Solon and Plato.

NOW AVAILABLE — A portable do-it-yourself MEDITATION PYRAMID KIT now offered for sale with instructions by the Pyramid Guide. As power develops along ridges and corners without loss of energy minus panels, corners and capstone apex can be purchased as a unit. Buyer can secure lengths of 1/2" tubing at local hardware or plumbing shop, placing ends inside slots at corners to construct framework for desired height. Write for Meditation Pyramid Brochure, El Cariso Publications, P.O. Box 176, Elsinore, Ca. 92330.

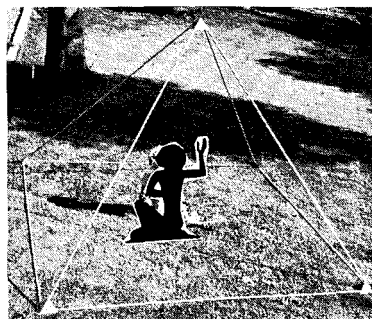

Pyramid House Plans \$1.00
Delta Structures
Dept. P.G. 15 Box 2382
Norman, Oklahoma 73069

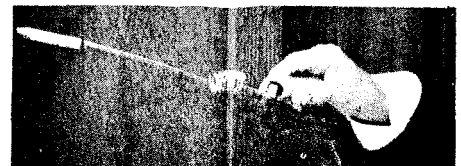
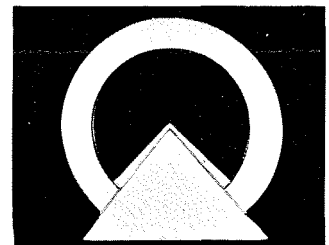

PSYNETICS FOUNDATION



- Self-Discovery
- Psychic Development
- Spiritual Growth

- LECTURES • CLASSES
- RESEARCH PROJECTS

Write: Psynetics, Dept. PG
1212 E. Lincoln Ave.
Anaheim, CA 92805
(714) 533-2311

"The New Atlantean Journal"

A new concept in total reporting! An Occult/UFO/Forcean information outlet featuring factual news events in all these fields. Scientific and analytical articles by well known authors, National and International UFO reports PLUS a Person to Person CONTACT page, Predictions and Psychic experiences! \$4.00 yearly on a quarterly basis — Foreign \$5.00. Send subscriptions to: Barbara Lucas, 6290 34th Ave., North, St. Petersburg, Fla. 33710. SAMPLE COPY \$.25. Edited by Joan O'Connell.

We Honor

MASTER

CHARGE

on all

Books and

Product

Purchases

The Original Cameron Aurameter, World's most Sensitive Dowsing Instrument, (Combination water compass, weighing device, and upright pendulum) \$49.50. Over 4,000 in use worldwide today. Exclusively available through El Cariso Publications. Write for Free Descriptive Brochure. P.O. Box 176, Lake Elsinore, Ca. 92330.

FOUNTAINHEAD

"The Fountainhead", an informative periodical describing psychic, astrological, metaphysical, and occult activities in and around Tucson, Arizona. The Fountainhead is also the source for books, gifts, lectures, and seminars on the occult, operated by Bob Moser and Vergie Trice. Location: 4044 N. First Ave., Tucson, Arizona, 85718 \$2.00 yearly.

HERE & NOW

is North America's most complete monthly guide to New Age events.

HERE & NOW features:

- ▶ The Uni-Com Calendar --- giving times, places, fees & descriptions of hundreds of classes, films, lectures & services every month.
- ▶ Up-to-date reports on discoveries suppressed by the news media.
- ▶ A guide to organizations, counselors & teachers in your area.

One year \$6.50 prepaid (\$7 if billed). Name: _____
Two years \$11.50 prepaid (\$12 billed). Address: _____
Foreign: \$10 per year, prepaid. _____
Payment enclosed _____

Send to: UNI-COM, Box 11716-A, Palo Alto. Ca. 94306, U.S.A.

finest spiritual and scientific information in the psychic field.

THE *Psychic Observer* SUBSCRIPTION FORM
E/S/P r e s s . I n c . and CHIMES
ONE YEAR (12 issues) \$7.50
Canadian and Foreign Subscriptions \$9.50 per year

NAME _____

STREET _____

CITY _____

STATE _____

ZIP _____

MAKE CHECK PAYABLE TO *Psychic Observer*
Box 8606, Washington, D.C. 20011

SPACE CONTACT ODDITY.....

YOUR TV SET AS A UFO DETECTOR

THIS AREA OF RESEARCH INVOLVES ENERGIES AND FORM, REAL OR IMAGINED. GOOD SEARCHING....

ADJUST YOUR TV SET TO MAXIMUM CONTRAST. TUNE TO CHANNEL 13. DARKEN YOUR SCREEN AND TUNE IN CH. 2. THIS SHOULD PULL IMAGES OF UFO'S CAVORTING IN THE SKIES ABOVE YOUR AREA. LOOK FOR DARK AND INTERMITTENT WHITE BANDS. A NEARBY SPACE VEHICLE SHOULD WHITEN THE ENTIRE SCREEN.

ONE CAN DISCERN BETWEEN SAUCER-LIKE OR MOTHER-SHIP (CIGAR-SHAPED) CRAFT, IF THE VESSELS ARE HOVERING OR MANEUVERING ABOUT.

AN ANTENNA ISN'T MANDATORY, BUT A GOOD AREIAL WILL BRING IN MORE DISTANT FLYING OBJECTS. A ROTARY ANTENNA AIDS IN NOTING THE DIRECTION OF TRAVEL.

A UFO APPARENTLY SENDS OUT ELECTROMAGNETIC FIELDS IN THE 27 TO 70 MEGACYCLE RANGE, CHANNEL 2. OPERATES IN THE 54 --55 BAND. CH. 13. SERVES IN THE STEP PROCEDURE ONLY. A DARKENING SCREEN STOPS THE FLOW OF ELECTRONS. THE CLOSE-BY UFO'S MAGNETIC FIELD INTENSIFIES THE WHITENING IMAGE ON YOUR TV SCREEN.

J.C. PARSONS, PO BOX 57, MANCHESTER, TENN. 37355, SAYS THE UFO ALSO AFFECTS ELECTRIC MOTORS, GENERATORS AND RADIOS. "THE PRESENCE OF STATIC ELECTRICITY CAN BE FELT IN THE HAIR AND ON THE SKIN OF THE OBSERVER." PARSONS MANUFACTURES A HORIZONTAL DEFLECTOR AND A STATIC DETECTOR DEVICE, AS A BACK-UP SYSTEM.

"SUSPEND A SMALL MAGNET BY SEWING THREAD FORM THE CEILING. ALLOW THE MAGNET TO HANG INSIDE --BUT NOT TOUCHING-- THE INSIDE OF A SMALL WINE GLASS SITTING ON THE FLOOR. A MAGNETIC FIELD CAUSES THE MAGNET TO TINKLE AGAINST THE SIDES WHEN A UFO IS PRESENT.

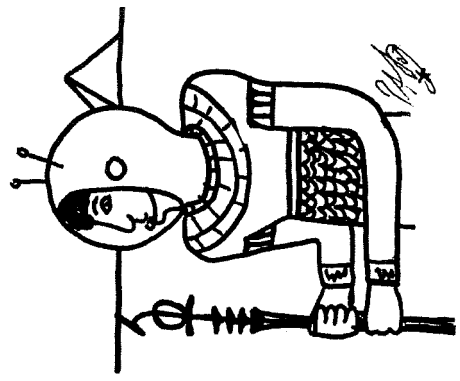

NEW MIRRORED GLASS, SOLAR PYRAMID HOUSE GRACES CALIFORNIA'S, SIERRA MADRE MOUNTAINSCAPE

John McKinny and Tom Regan, principals of California Architects, located in a 1926, recycled factory loft, designed this living laboratory for the development of solar systems in relative proportions to the Great Pyramid of Giza. The pyramid home is perfectly aligned with the cardinal points of the compass, with the master bedroom precisely situated in the king's chamber level, one-third the distance up from the base, directly below the apex.

The mirrored glass shell is supported on a triangulated metal space frame. It sits on an open, two-level glazed tile plaza. A hydraulic, sliding circular door provides entry to the house through the sub-plaza dominated by an open fireplace and sauna. Sculptured stairs lead to the main plaza comprizing the living, dining and kitchen area. A 10 x 10 lounging dais in one corner reveals a panoramic view of the sprawling Los Angeles basin and Pacific Ocean beyond.

A three-story wood kiosk springs from the upper plaza with kitchen on the first floor, a master bed on the second, and private office at the top. The total interior design abounds with an intense planting of flowering trees, balanced by minimal use of furniture, according to the unusual interior design.

A continuous perimeter opening at the pyramid base and louvered vent at the apex -- a venturi effect -- results in a natural system of cooling and ventilation. Solar panels will produce low heat transmission, cooling and electrical power, and light during daytime hours. Adjustable venetian blinds -- utilized on the south and western sides will reduce glare and heat absorbtion when desired. A twelve-foot, diamond-shaped, rotating photoelectric cell has been proposed for generation of the home's electrical service. For additional information write to: California Architects, 9328 Santa Monica Blvd., Beverly Hills, Calif. Phone (213) 278-1374.

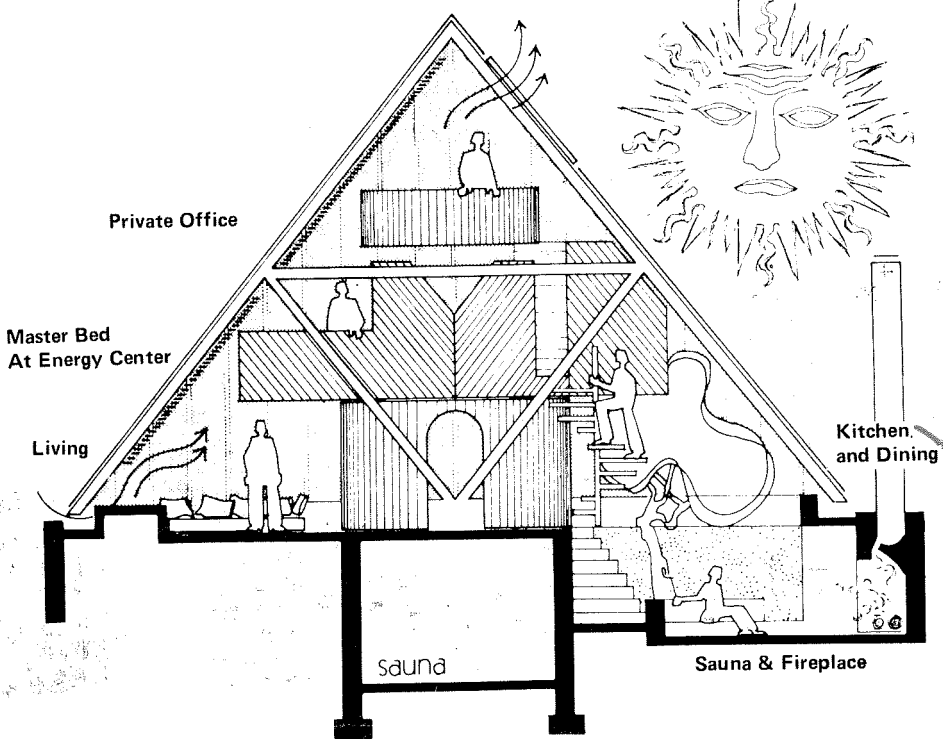

P.O. Box 176
Elsinore, ca. 92330

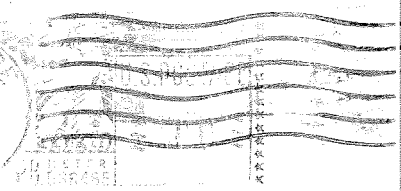

FIRST CLASS