

Volume 11

Autumn 1937

No 3

Editorial: Charles E.O. Carter

National Astrology by Estelle Gardner

Neptune Lecture by C.E.O. Carter

The missing ball by Luna Leo

The tragedy of the "Pocket Chancellor" by Mabel Baudot

Letters to the Editor

Some notes on transits by C.E.O. Carter

Reviews

ASTROLOGY

The magazine ASTROLOGY is conducted upon purely non-commercial and idealistic principles. All contributions and all services (other than printing) are rendered voluntarily and gratuitously in order to assist in spreading a knowledge of astrological science in all its aspects. Readers are invited to co-operate in this work in the above spirit.

VOLUME ELEVEN

SEPTEMBER

NUMBER THREE

OCTOBER NOVEMBER 1937

EDITORIAL

Change of Address

I HAVE to draw readers' attention to an alteration in my address (see cover), which is not due to any mobility on my part, but to the activities of the G.P.O.

A New Feature

A member of the Lodge has volunteered to conduct a section for advice, more particularly on psychological difficulties, matters of the affections, education, and proper understanding of children. I deeply appreciate this offer, and I believe readers will also do so. See page 113.

Radix Measure versus the One Degree

In his article on the Duchess of Windsor, Mr. Bray tells us that he rejects the one-degree measure, and prefers the radix because the former has no natural basis. This, I think, is true; it has no natural basis. But it may have an ideal or mathematical basis. There is, so far as I know, no *natural* basis for the division of the circle into twelve signs and thirty-six decanates, yet astrologers accept these.

The proof, then, lies in actual practice, and this seems to indicate that each method has some validity, though I fancy the one-degree increment produces general conditions rather than definite events.

But personally, like Mr. Bray, I incline to the radix as the more important, and the question arises as to whether all symbolic measures should not be converted to the radix equivalent. The preference of experienced astrologers such as V. E. Robson must be given due weight.

For the benefit of beginners I may say that the conversion of the o-d measure to the radix equivalent is very simple, apart from the use of tables.

Take the o-d arc, add to it as many minutes as there are degrees, and then subtract as many minutes from the result as there are tens of degrees in the original arc.

Thus, if the o-d arc equals $55^{\circ} 33'$, we should add $56'$ ($56'$, not $55'$, because $55^{\circ} 33'$ is nearer to 56° than to 55°), and then subtract $6'$ (because $55^{\circ} 33'$ is nearer to 60° than to 50°), yielding a result of $56^{\circ} 23'$ as the final arc by radix measure, operating approximately ten months later than the o-d direction.

It is only right to add that some astrologers have declared their experience that both measures are quite useless. But one may comment on this with the remark that there are very few astrological factors and methods that *someone* has not rejected with scorn and contumely.

There are those amongst us who will not even progress the angles of the horoscope, although it is probable that 49 out of 50 astrologers would say that the directions so resulting are of prime importance.

But one thing is certain, and that is that the ordinary "progressed horoscope" of my astrological youth is utterly inadequate.

The Question of Cruelty

It is not surprising that remarks on the natus of General Franco have occasioned a brisk correspondence.

As editor of an astrological publication I am, of course, neither Fascist, Nazi, nor Communist, nor as a private individual am I very eager to taste either régime *in propria persona*. England is good enough for me, whatever faults she may possess, though I have had many kindnesses from foreigners (despite an afflicted Jupiter), and hope that I can admire their virtues and appreciate the part which every great nation has played in history.

As regards the cruelty or otherwise of any individual, I, for one, find this a most difficult point to judge, probably because cruelty is not, psychologically, an isolated quality, but usually arises from deep-seated complexes. For example, it is probable that the cruelty of certain Roman emperors was not cruelty *per se* at all, but the result of fear. Thus we may have a Saturn type of cruelty as well as that of Mars, Uranus, or Neptune.

Mars square Saturn is often considered a cruel contact, but two of the kindest people I know have it. Charles II, a man of outstanding mercy (for his times), had Moon square Mars;

and Alan Leo had the same aspect, with a debilitated Saturn exactly on the ascendant, yet he was far from being a cruel man. As for Sun square Mars, I should never regard that as having great effect on the interior character, though it would tend to rash and extreme action, as we have seen in Franco's case.

Some very cruel actions have been perpetrated by very conscientious (though ignorant) men, such as the Inquisitors.

My own judgment would concur with Mr. Sampson in so far as I doubt whether a man with his ruler in Pisces would be likely to be essentially cruel, but it is patent that Franco, whatever his original point of view may have been, did embark upon a path that has led to untold suffering, and the blood-spattered path that he has trodden is shown clearly enough in his nativity.

The old question arises: how do we distinguish between character and destiny in a horoscope? A difficult, but not necessarily impossible problem.

Astrology gets behind both conceptions to something which is the common factor or root of both, something that may be called a man's astrological totality or *totum*.

If we accept human freedom of choice, then this would seem to appear mainly in the liberty man may have to decide for himself whether he will allow his *totum* to manifest in terms of character or of circumstance.

May we not hazard the opinion that because Alan Leo, for example, a naturally hasty-tempered man, elected to curb this predisposition and all other animal propensities, therefore that part of his astrological *totum* which was represented by Moon square Mars was diverted from the sphere of character into that of destiny and so occasioned his early death by cerebral hemorrhage?

Of course much can be gleaned from the houses occupied. But these change as the natus progresses, and in any case produce enigmas of their own. It is difficult for me to think that Leo had an afflicted Moon in the 9th in Aries, for, even allowing for the good aspects that it also had, this would have been hard to reconcile with his high principles. I believe that it was more probably an 8th-house influence. But here we are indeed on debatable ground.

Horary Figures and Radical Positions

In the practice of horary astrology it is usually thought that no notice should be taken of any radical positions; indeed it

is often asserted that this fact is one of the strongest things to be said in favour of this branch of our art, inasmuch as it can, on this supposition, be used just as well by a person ignorant of his birth-time, and even his day of birth, as by anyone else.

It is probable that this usage is perfectly correct when a figure is cast about a purely impersonal matter, such as: Will there be a war soon? Will the price of gold rise? And so forth. Indeed in such cases there is obviously no known radix to bring in.

When, however, we cast a figure about our own affairs I am sure that the radical positions must be inserted. For example, if a man were to ask himself: "Should I purchase this house?" I should consider that his own radical planetary places, inserted in the horary figure, would be important. I came across a recent case where a man bought some shares because the H.F. showed Pars conjunction Jupiter in the 5th. But the result has been unsatisfactory, at any rate to date, and actually Pars and Jupiter were both opposed to his radical Saturn. This planet, incidentally, is not, in my experience, a very fatal influence in financial questions, but he naturally causes delays, and, whatever the upshot of this particular case, it is certain that the same shares could, a little later, have been purchased at a much lower price.

The further question arises as to what should be done by an astrologer who is asked a question by another person, as happens in professional and also often in amateur practice; ought the querent's radical positions to be inserted in the map that is set up? It would seem that the logical answer would be in the affirmative.

It would be interesting to hear the opinions of experienced students.

Some students, when confronted with a decision to be made, simply examine their transits and decide from these whether or not they are likely at that moment to be faced with a favourable opportunity or a dangerous temptation. A horary figure in which radical positions are inserted obviously includes the transits, but it also comprises current positions and the current mundane scheme in relations both to radical and current planets.

C. E. O. CARTER

AUTUMN CONVENTION OF ASTROLOGERS

TO BE HELD IN

LONDON

AT THE

BESANT HALL, BAKER STREET, W.1

SEPTEMBER 24th, 25th, and 26th, 1937

Under the auspices of the Astrological Lodge of London (T.S.).

THE following Lecturers have kindly promised to speak and to lead discussions:—

CHARLES E. O. CARTER, B.A.

(President of the Astrological Lodge)

MRS. A. SUDBURY HURREN, L.I.F.A.

(Secretary of the Astrological Lodge)

DR. E. E. DICKINSON (London)

DUNCAN MACNAUGHTON, M.A., LL.B. (Edinburgh)

J. M. THORBURN, M.A., B.SC. (University of Wales)

P. J. HARWOOD (Brighton)

EDGAR BRAY, B.SC. (London)

W. FRANKLAND (London)

WILFRED JAMES (Sheffield)

R. S. GLEADOW (London)

MISS KEY (Liverpool)

MISS E. GARDNER (London)

MRS. ALLEN CHUBB (London)

MISS J. HARRAP (London)

MRS. D. RYAN (London)

Friday, September 24th

7.0 p.m. Reception by the President and Mrs. Hurren.

7.30 „ Address of Welcome by the President.

7.45 „ Lecture on "Astrology and Modern Thought."

Speaker: Mr. J. M. THORBURN, M.A., B.SC. To be followed by Mr. W. JAMES, Mr. P. J. HARWOOD, Mr. R. S. GLEADOW, MISS KEY, MRS. RYAN, and others.

Saturday, September 25th.

11 a.m. "National Astrology—Two Revolutions." MISS E. GARDNER.

Chairman: MISS HARRAP.

3.0 p.m. "Medical Astrology." DR. E. E. DICKINSON.

Chairman: MRS. ALLEN CHUBB.

- 5.0 „ Tea and Social Gathering.
 7.0 „ "The Radix System." MR. EDGAR BRAY, B.SC.
 8.30 „ "Symbolics." MR. W. FRANKLAND.
 Chairman: MR. R. S. GLEADOW.

Sunday, September 26th.

- 11 a.m. "Early Zodiacs." MR. D. MACNAUGHTON, M.A., LL.B.
 Chairman: MR. P. J. HARWOOD.
 3.0 p.m. "Education." MRS. A. SUDBURY HURREN.
 Chairman: MR. C. E. O. CARTER, B.A.
 5.0 „ Tea and Social Gathering.
 7.0 „ "The Work of the Convention: A Summing-Up." MR.
 C. E. O. CARTER, B.A.
 Chairman: MRS. A. SUDBURY HURREN.

Monday, September 27th.

- 7.0 p.m. Social at the Astrological Lodge, 6, Queen Square, W.C.1.

Artists:—

MISS RITA SHARP ('Cello).
 MISS C. O'BRIEN (Piano).
 MR. DUNSTAN HART (Baritone).

Refreshments.

Address by MR. C. E. O. CARTER, B.A.

Tickets for all meetings, price 5s., to be obtained from:—

MRS. A. SUDBURY HURREN,

49, TWYFORD AVENUE, EAST FINCHLEY, N.2.

As accommodation is limited to 400 and a large number of applications is expected, tickets should be ordered as soon as possible.

The evening meeting on Sunday, September 26th, will be open to members of the Astrological Lodge and its affiliated bodies only. This restriction has been rendered necessary as the Main Hall will not be available at this time and the Meeting will be held in the Refreshment Room.

All those attending the Convention will be welcomed at the opening Social of the Astrological Lodge at 6, Queen Square, Bloomsbury, on Monday at 7 p.m.; see above.

NATIONAL ASTROLOGY

By ESTELLE GARDNER

It is pleasant to be able to begin by saying that the autumn quarter looks like being on the whole a great improvement on the last, especially where foreign affairs are concerned. By the time these words appear in print we shall, let us hope, have passed safely through August, which, as I said in April, is likely to be a very critical month, and the Libra Ingress should usher in a period of considerably less tension, and generally better conditions.

The Sun enters Libra at 11.13 a.m. G.M.T. on September 23rd at London, with Scorpio $26\frac{1}{2}$ rising, and Mars in the 1st in Sagittarius, an echo of the Spanish preoccupations of the summer, and a reminder that the Spanish question is still with us. But Venus, ruler of 7th, is in the 9th, two degrees past a trine to Mars, and Paris, Berlin, and Rome all get the benefit of this trine. It is fatally easy to draw wrong deductions in astrology through overlooking some vital factor, but this particular combination seems to me to justify the hope that by October the end of the Spanish conflict will be in sight, or, if that be too optimistic (for at the time of writing it seems impossible), that it will be in some way insulated, and no longer such a danger to the peace of the rest of Europe. In April I gave my reasons for thinking that the fighting will go in Franco's favour in August, and although a hard struggle may well take place in September, when Mars opposes the place of the eclipse of June (which squared the 10th house ruler of the map of the Spanish Republic, Madrid, April 14, 1931, 5.50 p.m.), yet at the Libra Ingress, with the first degree of Sagittarius rising at Madrid, the ruler of the ascendant is in the 2nd, trine the ruler of 4th in 10th, and this must surely be an indication of improving conditions within the country itself. The progressed Sun of the Spanish Republic is entering a new sign this month (July), and this is a happening which is nearly always an indicator of pronounced change.

At home Mr. (now Earl) Baldwin resigned the Premiership on May 28th, and the composition of Mr. Neville Chamberlain's ministry was formally announced at 3.30 p.m. G.M.T. on the same day. This time gives Libra 20 rising, with Venus in the 7th, squared by Pluto on the M.C. and by Jupiter from the 4th. We are still handicapped by insufficient knowledge of what may be expected from Pluto, but the prominent position which he occupies in the maps of almost all governments

to-day would lead one to suppose that he has, at any rate, much to do with currency and economic problems. My own observations also lead me to think that he has some connection with the rise of the ideology of Fascism or National Socialism, as opposed to that of Communism or International Socialism (connected with Neptune), but I only put this forward as a tentative suggestion for research. His advance into Leo ought at any rate to shed some light on his precise significance, but although he will touch this sign during October and November of this year, he cannot really be said to enter it until August 1938.

In the map for the original formation of the National Government (August 24, 1931, 4 p.m. G.M.T.) the Moon was in Capricorn, conjunct Saturn, and exactly opposition Pluto from 1st to 7th. In the map of the present ministry it is also in Capricorn, with the Sun in Gemini, a combination which, in a personal horoscope, gives good business ability. Mars is strong in the 2nd house of the map, in trine to Pluto on the M.C., and in sextile to Jupiter in the 4th. Rearmament will continue according to plan during the life of this ministry, and much money will be spent on it, but our prestige (10th) and home conditions in general (4th) will benefit therefrom. Add to the Sun, Moon, and 2nd-house influences the Libra ascendant, and you get a very fair picture of the chief aims of the present Government, i.e. to strengthen our national defences, and to hold the balance and endeavour to walk the middle way, especially in foreign affairs (ruler in 7th).

The coming quarter should be a prosperous one, for we find Jupiter in the 2nd at the Libra Ingress, forming part of a grand trine to 10th and 6th houses. Employment and trade should be stimulated under this influence, and there should be a revival of confidence on the Stock Exchange. There is, however, an opposition of Sun in 10th to Saturn in 4th in the map, so that the last week in September and the first half of October may be critical in some way under this influence, either for the Government or for the country as a whole, especially as Mars (ruler of 1st) squares this opposition by transit during that time. Mining or agricultural matters or interests are likely to be adversely affected by this position. In Italy, where at Rome the opposition is closer to the cusps of 10th and 4th than it is at London, an earthquake would not be a too unlikely happening, and at Berlin it may show the result of a bad harvest, of great importance to a country endeavouring to produce its food supplies within its own frontiers. As far as Empire affairs are concerned, I should not

be surprised if this constellation proves to have some connection with Palestine, since the Sun rules the 9th, Aries rules Palestine, and the publication of the Palestine Report has brought the country into the limelight.

Present-day Palestine may be said to have finally come into being at the moment of General Allenby's entry into Jerusalem at noon on December 11, 1917 (the city was captured from the Turks two days previously, but this was the formal entry). The figure for that time is an interesting one, if only because we find the dual sign of Pisces rising, and two peoples claim the country, one largely composed of refugees (12th-house sign), and the traditional sign ruling Turkey, Virgo, is on the 7th. Then there is an opposition from 6th to 12th houses, a further indication of the racial question, for the planet in the 6th (house of the masses) is Saturn, traditional ruler of the Jewish people, placed in the ruling sign of Leo, and the Jews wish to possess Palestine for themselves. And the planet in the 12th, Uranus, is in the sign of Aquarius, given by the old textbooks as ruling "Arabia the Stony," or the northern part of Arabia (the part contiguous to Palestine), and the 12th house is the 6th from the 7th, i.e. the people of the country under its Turkish rulership, the Arabs. This opposition is mitigated by the Sun in Sagittarius on the cusp of the 10th, symbolising rulership from outside the country (9th-house sign), and the power of Great Britain, in sextile to one planet and in trine to the other, striving to hold the balance between them. But the eclipse of last June fell in opposition to the Sun, and in square to Mars in the 7th. The report is unpopular, and the months from August to November are likely to be extremely critical. The August New Moon falls on the 6th-house Saturn, and squares the radical Moon in the 8th. The September New Moon opposes the ascendant, while during the second and third weeks Mars by transit will pass over the Sun and M.C., squaring its own place and opposing the place of the June eclipse. And the November New Moon falls on the radical Moon in the 8th, and squares the radical Saturn, with which the progressed Moon will be in conjunction that month. Some rioting and violence is likely to result from all these adverse factors, or will at least be attempted, but with Jupiter, ruler of 10th, in trine to the radical Mars by transit, the Government should have the situation well in hand. The Jews are in a stronger position for bargaining than the Arabs, since their representative planet (Saturn) is more favourably placed by transit. The positions in the radical map lead one to think that in the end the country will settle down on the basis

recommended by the report, for the dual sign of Gemini is on the cusp of the 4th, with its ruler, Mercury, in the 10th in Capricorn. But Mercury is opposed by Pluto, so that we here once again come up against the unknown quantity represented by that planet, and time alone will show how far such a settlement can be permanent.

Returning to Europe we may take a glance at affairs in France, where M. Blum's Government, which had been in office just over a year, fell on June 21st, and M. Chautemps accepted the President's request to form a new Government at 7.30 Summer Time on that morning, according to *The Times*. That hour may therefore be taken for the map of his ministry.

An examination of the present condition of the radical map of the French Republic (September 4, 1870, 4.45 p.m., Paris) shows Pluto to be very active in France. The progressed Sun is opposing his radical place from the 9th, and by one-degree measure he is opposing the ascendant of Capricorn 27, and over the Mars-Uranus conjunction in 25-27 Cancer which is such an unfortunate feature of the map. Evidently the group of degrees 25-29 Cancer-Capricorn is of importance to France. M. Blum's own ascendant is Cancer 26; he therefore received the full force of the Republic's Cancer constellation. In the map of M. Chautemps' Government (I have no information as to his own map) we find an ascendant of Cancer 29, and the transiting Pluto therefore in conjunction with it. Once more the 7th-house influences of the radical map of the Republic are brought to the ascendant of its Government. The same conditions will therefore be operating, the same problems concerning currency and gold (Pluto), and the same generally tangled financial conditions (Sun ruler of 2nd on cusp of 12th going to square of Saturn). A long life for the Government seems unlikely. It will almost certainly have to face a crisis early in August, and perhaps will no longer be in existence when these words appear in print. Although it has already made energetic efforts to grapple with the financial situation, and has devalued the franc against much opposition, its demise when it comes will probably also be due to financial matters, since the rulers of both 8th and 4th are in the 2nd-house sign of Taurus; possibly these matters will be connected with taxation (8th), an ambitious programme for which has already been launched. For those who are not familiar with the radical map of the French Republic I might mention that an important feature of it is that the ruler of 11th (parliament) is weak in 5th, opposed by the ruler of ascendant in 11th; recurrent

governmental crises are hence inevitable at any time, and at present the action of Pluto is complicating matters still further.

Mars forms its conjunction with Jupiter in Capricorn 21 on October 30th, and this conjunction falls on the midheaven of the map of the Nazi Government (January 30, 1933, 10 a.m. G.M.T., Berlin), trine the radical Mars-Jupiter conjunction in the 6th, and opposition Pluto in 4th; mixed influences therefore. I cannot help thinking that this position will prove to have some reference to the German Church conflict, for Mars-Jupiter contacts are so often connected with religious matters, and that it will foreshadow either some fresh development, or possibly the outcome of a crisis, followed by a much-to-be-hoped-for settlement of this distressing question.

At Washington the Sun-Saturn opposition in the Libra Ingress map falls across 1st and 7th angles, which leads one to anticipate some kind of difficulty with regard to foreign affairs. As Aries is the traditional ruler of Japan, this difficulty may have something to do with the situation in the Far East. The opposition probably also has continued reference to the conflict over the Judiciary Reorganisation Bill, which opened in the Senate during the first week in July. In the map of President Roosevelt's second Administration (January 20, 1937, 29½ minutes after noon, E.S.T., Washington), Saturn, ruler of the 9th (law) is placed in the 11th (parliament), almost exactly opposed by the ruler of the 11th itself. Legislation relating in some way to law is therefore likely to be prominent during the life of the Administration, but any such legislation can only be carried through against the most strenuous opposition. My April prediction of a possible loss to the President's Government by death was fulfilled when on July 14th Senator Robinson, the Arkansas Democratic majority leader, who had been leading the fight to secure the passage of the Judiciary Bill, died suddenly of heart failure. I mention this because in as far as I understand the matter (*The Times* is my source of information), his death may have important political repercussions affecting this very affair. The months of June and July have been exceedingly difficult for the President; August, September, and October should be somewhat easier, for Jupiter will be transiting in trine to his ascendant; November will be critical again, for the New Moon squares his radical Sun (which by progression is squaring the radical Moon). There is likely to be considerable expenditure on the fighting services during the quarter, but Jupiter strong in the 4th house of the Ingress map should benefit home conditions in general, and conduce to prosperity.

With regard to the situation in the Far East, I gave last autumn, in a talk on Japan, astrological reasons for thinking that either a constitutional crisis or a foreign adventure would develop in that country about June of this year. My conclusion were based on the present condition of the map of the Emperor, and that of the Japanese Constitution (February 11, 1889, 10.30 a.m. Standard Time, Tokyo). I gave also reasons for thinking that at present the stars are with Japan, and that whatever plans or policies she may have in mind are likely to be successful. These reasons are too lengthy to be restated here, and time alone can prove whether my deductions were correct.

In conclusion, I will repeat my first sentence. I *do* think that the astrological signs point to a less complicated and more prosperous quarter before us, and I hope sincerely that I may prove to be right.

Written July 24, 1937.

NEPTUNE

A Lecture given at the Astrological Lodge, 6, Queen Square, W.C.1, on October 14, 1935, by

C. E. O. CARTER

IN his fourth Georgic the poet Vergil relates the myth of Aristaeus, the shepherd who, having lost his bees through disease, seeks the advice of his mother, the sea-nymph Cyrene, as to the manner in which he may regain his prosperity. She, in turn, sends him to Proteus, a sea-deity who possessed the power, when pursued, of changing his shape and so eluding his pursuer.

Cyrene instructs her son not to be deceived by these transformations, and to seize the god when he lies asleep on the shore. The shepherd carries out her instructions, subdues the god, and learns the cause of his troubles. He had assailed Eurydice, the bride of the initiate-bard Orpheus, and she, in fleeing from his undesired attentions, had trodden on a snake and died of its bite. Aristaeus, then, must sacrifice to Orpheus and Eurydice, and so recover his good fortune. He does so, and finds a fresh swarm of bees.

This is the myth that seems peculiarly related to the planet Neptune.

Like all the sacred myths of the Greeks, it is susceptible of

several interpretations, but I venture, for our present purpose, to read it as follows:—

Orpheus is the Spirit in man, and Eurydice is the Soul. Aristaeus is the animal propensity, or so-called animal soul, and this last, giving way to its impulses, assaults the Soul, in a figurative sense, whereby she suffers apparent injury and death, although, because of her essentially divine nature, she cannot really die. But now Aristaeus, having alienated himself from his superior principles, begins himself to suffer disintegration, and so loses his "bees," i.e. his various human faculties.

In this plight he seeks help from his mother Nature, for, having separated himself from higher principles, it is to Nature only that he can go. But Nature, in her external aspect, cannot solve the problem, which relates to deeper mysteries than hers, so she directs her son to Proteus, who is symbolic, in my reading, of the subtle and hidden forces and correspondences behind Nature upon which the mantic arts are based.

Cyrene knows how to deal with Proteus, for she may be said to represent Nature in her totality, and the god assists Aristaeus to re-integrate his own nature to those higher principles upon which all human well-being ultimately depends.

I think this myth makes a very good beginning for the study of Neptune, who, mythologically, rules the sea; Proteus, as a lesser sea-deity, is obviously an aspect of him.

The word "nature" means "that which is born," and the Greek word, "phusis," means a shoot or sprouting. Both terms refer to that endless variety of forms that Nature pours forth perpetually, playing, as it were, multitudinous changes on the patterns that she receives from the Great Architect. We may say that the substance of Nature—astral matter, if you like—is possessed by a perpetual thirst for fresh forms, and this characteristic is stressed in the Proteus-myth in the emphasis laid on the *changefulness* of the god.

Bearing in mind this dominant feature of Neptune, we can see plainly the reason for some of its main exoteric traits.

Firstly, we know why it is that the Neptune person, and the Neptunian thing, are *never just what they seem to be*; there is always an element of deception, though it may be perfectly innocent deception. This comes out very markedly in the love of the stage that characterises the Neptunians; they seem to delight both in changing their outward being, and in watching others do so, and the more completely the actor is lost in the part, the greater their delight. Watch a music-hall impersonator (if the cinema—another form of Neptunian illusion!—

has left any of them alive) and see how his art consists in rapidly assuming the outward appearance of a dozen widely different characters: that is Neptune in full action.

From the same source comes the Neptune love of the ever-changing sea and also of the mighty panorama of the clouds.¹

Typical examples of the manner in which the person born under Neptune is often different from what he seems are, first, that he is often robust in appearance, but actually not so, secondly, that he often looks much younger than he is, and, thirdly, that the appearance is often bold and self-confident, whereas in reality the native is timid.

Not only is Neptune deceptive of others, but he very often deceives himself, in the many ways with which modern psychoanalysis have made us to some extent familiar. And when we are taken in, it is often as an outcome of our own interior folly. In that most typically Neptunian play, *Midsummer Night's Dream*, Bottom is an ass himself before he becomes actually capped with an ass's head in the fairy kingdom, and when Ariel remarks "Lord, what fools these mortals be!" he is saying what one imagines Neptune himself may often be tempted to say, as he watches our strange antics!

I once knew a very sweet lady who succumbed beautifully and naturally to an afflicted Neptune. She loved theatres—but she had always been taught to consider them rather wicked, and perhaps those she liked *were* wicked. From a Saturn point of view there was nothing to be done; she would have to do without theatres. But Neptune soon suggested a way round this difficulty. If theatres were wicked, it was plainly her duty, as an "old soul," to visit and cleanse these polluted places. So she decided to visit a theatre once or twice a week, and give it an astral cleansing. This she did, and noted a great improvement in their condition after every purification! She asserted that her duty in this matter was communicated to her by a saint, with whom she was astrally in constant contact, and whose authority could not in any circumstance be questioned.

The production of a *deus ex machina* in the form of some "master" or other hypothetical authority, is a common Neptunian phenomenon, relieving the recipient of these messages from any personal responsibility and from the necessity, sometimes uncomfortable, of giving a rational explanation for his wishes and actions.

Self-glorification is a widespread innate human instinct,

¹ Shelley had his ruler conjunction Neptune, and we may refer to his wonderful poem *The Cloud*.

appearing in the paint and feathers of the savage, the exhibitionism of the strutting child, the pompous bearing of the self-important adult, and the "tall tales" of the fisher, the golfer, and other sportsmen and players of games. When we are too truthful to tell lies, and yet possess no actual and palpable attributes about which to be vain, Neptune will often come to our aid through some spiritualistic or supposed "occult" communication which will assure us that, though apparently nobodies, we are *really* somebodies of great importance. This sort of thing often leads, of course, to sheer insanity, as when people delude themselves that they are the Almighty. But to believe that one is the reincarnation of Caesar, Cleopatra, or some other celebrity of the past, is but the first step in the same direction, and, under Neptunian affliction, we are all of us in differing degrees liable to take it. It may even take the form of making us believe ourselves to be wonderful astrologers!

Then, secondly, we see that it is right and appropriate that Neptune should have an *active imagination*. For this faculty is itself the most changeful part of man, and it enables us all to do a certain amount of play-acting within ourselves, so that we can, without fuss or bother, and without any real histrionic ability, play at being Hamlet, Mark Antony, Mussolini, or whosoever we will.

The close connection between Neptune and art in all its forms may also be ascribed to the imaginative powers of the planet, which, when creatively employed, can encompass wonderful results, especially in the Romantic school.

Thirdly, Neptune is the planet that is chiefly operative in *hallucinations, delusions, and other mental troubles*—although we must consider whether Pluto is not sometimes responsible for such complaints.¹ This is natural, inasmuch as such things are due to an over-active imagination that confuses the actual and the phantasmal; when there is a strong Saturn element in the horoscope, fear also occurs, and we get a phobic condition.

Fourthly, we relate Neptune to *clairvoyance and other cognate "psychic" powers*. Proteus himself was a psychic. Astrology itself is intimately connected with Neptune, which is nearly always prominent in the true astrological nativity. The Protean principle will possess powers that are beyond the normal because the god is not external Nature (and even that is mysterious enough), but he is the radical substance behind her.

The clairvoyance of Neptune is not, of course, a spiritual

¹ The long conjunction of the two planets in Gemini in the early 90's of last century may have led to misapprehensions.

quality, it results from the abnormal sensitivity of the planet. Proteus is a nature-deity and below the plane of Spirit.

Thus there is a mistake in proclaiming that Neptune is the spiritual planet *par excellence*. Nature with all her parts, including the planets, is an expression in terms of herself of spiritual principles, and it is the privilege of the astrologer to see more, perhaps, than most people of these spiritual significances—at any rate, he ought to. Neptune has spiritual significance, but so also have its brethren among the planets.

Indeed, we may recall that Saturn divided his kingdom among his three sons, and that the sea fell to Neptune. Now the sea is symbolic of the changing and the transient—it is the “ocean of generation” across which the soul must sail her boat.

Fifthly, Neptune is sometimes connected in our studies with *the wastrel, the criminal, and the life of the under-world*. Here, again, there may be confusion with Pluto, but there is some truth in a belief so widespread, and we may examine its basis.

I would say that as a general rule Neptune is not an aid to material success. Even when it is brilliantly aspected (as in the map of Cecil Rhodes, for example), the success is often either unsubstantial, or the native himself gets but scant joy from it. Rhodes died comparatively young, of a very terrible disease. Often it seems as if downright disasters occur as a result of so-called good Neptunian aspects.

The indeterminate, sensitive, and almost elfin quality of the planet is not suited for commercial, political, or military success, except indeed by exercising its powers of trickery. (Washington, for example, succeeded best as a general by reason of his great skill at methods of camouflage and deceptive tactics, and this seems to be due to his having had the Sun and his ruler in Pisces.)

So it is that, unless our Neptunian is able to make good in those fields that are peculiarly his own, e.g. occupations concerned with the stage or with the sea, he is often a failure. Proteus, after all, is not on the human plane or in the world of men at all; rather he belongs to the realms of faery, to the elemental kingdoms, all that is *just behind* what is seen and felt. Just behind—that is why he and his are so fascinating and yet so tantalising. This is true in some degree even of astrology. We study our science for many years, and accumulate great knowledge and experience, and yet, at any moment—and often at the critical moment—it reveals a fresh side to us, something never realised before.

But, to return, because the Neptunian is not of this world he is often a failure in it, and because he is often a failure,

he may sometimes be actually a criminal, seeking, by methods true to his own nature, to find a short cut to riches by some alluring way that may seem quite all right to him, but will wear a different aspect when it is unfolded before a judge and jury in the cold light of Saturnian justice.

The very changefulness of the planet will often lead to confusion, muddle, misunderstanding, and other conditions that ultimately bring the perpetrator into conflict with the law. Again, the quick-change powers of Neptune may be very helpful to the criminal, and may even invite criminality. "I could so easily imitate that signature," says the Neptunian, and before he realises it he has done the deed.

Further, criminologists tell us that vanity is a potent motive with many law-breakers, and vanity appeals to the Neptune imagination. Not all imaginative persons are vain, but most vain people are imaginative, for unless we really are wonderful individuals (in which case we shall not be vain at all) we must feed our vanity upon imaginary things.

Thus in my view Neptune is not essentially criminal, but it does possess several attributes that are liable to lead to crime. A prominent Neptune is, one might say, an excellent tool lying close at hand for its owner to turn to evil ends, if he wills to do so.

Sixthly, Neptune is *hyper-sensitive*; and this appears in the bodily characteristics, for the planet rarely bestows a robust frame, though often there is good general health. Proteus, after all, has not a body; he is something that constantly assumes different bodies. But it is the body, the outer husk, that protects us and makes us less sensitive.

Certainly Neptunians are very sensitive indeed, to weather, to the conduct of others, and, in fact, to all external conditions.

This characteristic involves them in much physical and emotional suffering; but it is also the secret of many of the powers they enjoy, not only those of a psychic kind, but also their appreciation of music, of colours, and even of tastes and odours. In reality sensitiveness is life; only the inanimate feels nothing. Thus, by being ultra-sensitive, Neptune gains a finer and fuller experience of life, and, provided the sensitiveness stops short of morbidity, it may well be worth while, even if it can scarcely lead to a comfortable existence.

Seventhly, and as a result of its sensitivity, Neptune represents *withdrawal and retirement*. This may be voluntary or it may be compulsory, as in the case of the imprisoned criminal or the lunatic in an asylum. One of the first evidences of this inhibitive action of the planet probably occurs when the child

is told that it may not "play in the garden to-day because it is raining." Neptune has much to do with weather, at any rate, English weather. In late middle age a Neptunian direction will often indicate retirement from business, and, at any age, the result of such an influence may be a spell in hospital, or the "long sea-voyage" which our physicians are so fond of recommending when they do not know what is the matter with us and want to get rid of us until we have recovered spontaneously!

Saturn is sometimes considered the inhibitive planet, but its action can be distinguished from that of Neptune in this way: Saturn does not usually inhibit our personal movements, but prevents our doing things by placing circumstantial obstacles in our way, very often of the nature of business or family responsibilities, or it may cause a grievous lack of pence. Neptune seems to impose more personal restrictions, either sickness of mind or body, or actual confinement in jail or institution.

Proteus is represented as a shy god who has to be waylaid when asleep; in point of fact, most nature-deities have the trait of being elusive, seldom seen, and seen at peril. To "see a nymph" was to lose one's reason. Neptune, being a nature-force, is also shy.

But I think he is the shy faun, rather than the hermit or ascetic. It is true that we associate monasteries with Pisces, and, presumably, to some extent with Neptune, but from an examination of the horoscopes of monks and nuns I have concluded that Neptune is not as prominent in such cases as one might think. It seems that Saturn is the prevalent influence in these, and the withdrawal of Neptune is to the woods and seas, to attain a greater liberty, a free natural expression, rather than to the discipline of the cell.

I like to think of this escape-aspect of Neptune, for we have all of us something of the planet in us, even if we are not distinctively under his sway. Within all of us, even the most prosaic, there is this call back to nature, to the mountain-tarn, the solemn pine-woods, to the fens and open stretches of heath. It is a strange call, and yet very intimate; it whispers in a voice that is all but imperceptible, and yet for some of us it is a never-ceasing appeal, as of something wild and free within us, half-human, half-animal, seeking to draw us back to its own kingdom, a land of magic, of beauty—and of danger also. To this region the safest and surest guides are the inspired musicians and poets.

With this withdrawal-aspect can be related the attraction

that drugs, and narcotics in particular, have for many Neptunians. These, of course, produce an artificial liberation of the Protean element in us and free us, for the time being, from the more obvious corporeal inhibitions.

It is strange that many Neptunians—by which I mean those with the planet close to the ascendant—have no love of drugs and often do not even smoke or care for alcohol in any form. The same people whom I have in mind in writing this are also averse to all psychic experimentation. Thus there are exceptions to all rules. The map must be negative in a wide sense to be indicative of the victim of psychic or chemical doping, and it is more than probable that certain zodiacal areas are specially concerned with such practices.

* * * *

These seven Neptunian characteristics appear to some extent in all who have the planet we are studying prominent, but we need not go to the extreme of supposing that all who have this horoscopic feature deviate widely from the ways of ordinary humanity. There is a normal Neptunian, just as there is a normal Uranian. Not all who are born under one or the other of these planets is either an adept or "master" (Uranus), or a saint and mystic, a kind of St. Francis of Assisi (Neptune). Nor are they necessarily black magicians or "lords of the dark face," if they have, say, Mars square Neptune.

Many persons with Neptune rising are mentally shrewd, and indeed often rather critical of others, with somewhat detached minds and the ability, because of Neptune, to see through the pretences of others with considerable insight. The business sense is often quite sound, particularly if the planet is in Taurus or Gemini. The Neptunian is not outstandingly religious in any formal sense, but he is charitable, and in particular has often a great love of animals, which is what we might expect, in view of the relation between the planet and Nature.

As we have said earlier, Neptunians are often very different from what one expects them to be. If they look resolute and bold, they will probably be afraid to go outside the house after dark; if they look weak and timid, they have probably won the Victoria Cross; if they appear thoroughly commonplace, they are likely to be highly gifted; and if they look "all soul," it is quite possible that they never think of anything but hats and hairdressers. But these disguises are usually quite involuntary.

It is true that Neptunians often misunderstand and give rise to misunderstanding. They often express themselves

obscurely or cryptically, or have some trick of speech or gesture that is liable to be misunderstood, and again I have known them blandly tell of something they have done which, to the other party, seems in extremely bad taste, if not actually dishonest; yet the Neptunian evidently has never looked upon it in that light, for he will even recount the action to those most likely to resent it, without any apprehension of offence. Because of this aptitude for self-delusion, one must be very circumspect in dealing with Neptunians, especially with those in whose map the planet is both prominent and afflicted, for, even if there is no actual deception, confusion, worry, and misunderstandings will usually arise sooner or later.

When one is personally under serious Neptunian afflictions one should take the warning that astrology gives, and be very thankful for it. At such a time scan the horizon with the utmost care and give the alarm to yourself as soon as the inevitable Neptunian element appears. It may come as a thing or circumstance (such as a plausible invitation to invest your savings in some enterprise connected with the sea, the films, artificial silk, and so forth), or it may come in the form of a man or woman who will enter the life with unfortunate results.

There is no better protection against Neptunian evils than good old-fashioned Saturnian common sense that minds its own business, is prepared to pay for what it gets, and hates sham, humbug, bluff, and self-advertisement. Above all, beware of the get-rich-quick canvasser and circulariser. If a lady, make no acquaintance of an intimate character until the good faith and respectability (in the best sense of the word) of the person have been well attested, and, indeed, a man may use equal caution with advantage. Astrological records contain many cases wherein engagements have been entered into—and sometimes even marriage—under Neptune influences, with the result that later the partner was found to be a hopeless alcoholic or drug-taker.

In regard to health, Neptune has a weakening effect, and this debility will be most in evidence in that part of the body which is related to the sign occupied by the planet, whilst the rest of the map must also, of course, be considered. Actual ill-health is not by any means necessary, but the native will probably not enjoy rude health and animal spirits. Just as purity of character and honesty of purpose are the best moral protections against Neptune, so bodily cleanliness, inner and outer, will go far to prevent serious corporeal results from the afflictions of the planet. Good air, clean water, and a plain wholesome diet, of not too heavy a character, suit this type

well, but it will be necessary at times, without becoming lazy, to rest the body and the emotional nature, too. Neptune spells "withdrawal," and an occasional voluntary acceptance of this law is better than an involuntary sojourn in hospital or home, perhaps of a prolonged kind.

As regards the work to be done in life, it seems as if Neptunians are fated seldom to come prominently before the public *in their own characters*, therefore—if they are ambitious of publicity—let them seek it through the stage, or perhaps through art and music. Again, they may excel as detectives; they are often fond of the sea, and may get positions either afloat or in connection with marine affairs; and, among trades, those of boot-making and boot-selling are Neptunian, owing to the relation of the planet to our feet, through its affinity with Pisces. Nursing is one of the primary Neptunian professions.

As regards Neptunian remedies, *phosphorus* and *iodine* suggest themselves, phosphorescence being an essentially Neptunian phenomenon, and iodine being derived from seaweed. We may with advantage study the uses of these substances as they are set forth in homeopathic literature, and also the types of human beings that are commonly related to them.

Among the races of mankind it is to the Celtic that I would relate Neptune, especially in its present condition. For the Celts inhabit the extreme west of Europe, and are largely a fisher-folk whose lives are closely connected with the sea. They are dreamy, unpractical, irresponsible, and, as races or nationalities, they are failures, driven into the recesses of the mountains by the conquering Saxons; and this despite their valour in war.

The Highlanders of Scotland are perhaps the happiest examples. They have the hospitality of Neptune and the generosity of Pisces, with a high sense of honour and pride of race. They are esteemed and respected by all; and yet their lot has been an unhappy one, for they lost the Lowlands to the invading Germanic race, and, much later, went in thousands to seek better fortunes overseas in New Zealand, Canada, and the United States. Clairvoyance and the old romantic outlook of the Neptunian prevail amongst them.

In Wales there is a strong Gemini element that has enabled the people, though defeated by the Romans and then expelled from England by the Anglo-Saxons, to survive and even flourish, for they are keen business men. However, the trickery of Neptune is ascribed to them by the English, who, even in the nursery, learn that "Taffy was a Welshman, Taffy was a

thief," and the very word "Welsh" has come to mean to escape from meeting one's obligations by running away. Yet the Welsh are brave, musical, and intellectual in a marked degree, and they have also a very strong religious sense, as have the Scottish Highlanders.

In Cornwall we have the same Celtic remnant and the same old legends and superstitions.

The Irish have the Neptunian charm and the Neptunian untrustworthiness. They have the reputation of always giving a pleasant answer, but of caring little whether it is accurate, and they carry responsibilities lightly; when their lack of reliability has caused you serious loss and inconvenience, you get a smile and a cheerful "Well, perhaps it's all for the best," and that is all the satisfaction you will receive. They, too, have the old Celtic folk-lore, the Celtic pride, and the Celtic self-pity, but they also are great in battle.

It would seem that a strong Leo element enters into the Celtic temperament, but with that we have no occasion to concern ourselves here; it is obvious that Pisces and Neptune are the two factors common to all the divisions of the race.

The French would appear to have suffered too much admixture of Latin and German blood to count as predominantly Celtic; they certainly have an element of irresponsibility, but they have also a strong sense of logic and an ego-centrism that appear more Latin than anything else.

It is true that the folk-lore of the Germanic nations shows a Neptunian element, as we have noted in such a typical work as *Midsummer Night's Dream*. But it is more grotesque and less morbid than the Celtic variety; it is often full of fun and mischief, and is seldom dreary and gruesome.

* * * * *

It must be admitted, in conclusion, that in its external aspect the 12th house and the sign and planet that are most clearly connected with it, are evil—they stand for self-undoing, sorrow, decay, and downfall; they are the end of things, the ruins from which new life has not yet blossomed; chaos, turmoil, the Dark Age of the spirit. The Hindus rightly regard the 12th as an essentially bad house, and, rightly too, the Greeks called it The Evil Spirit. A very great deal of the sorrow and tragedy of human life results from the action of Neptune, or at least is indicated astrologically by him.

In a word, the mystery of Neptune is the mystery of Sorrow. And as all religions and philosophies have, each in its own way, tried to solve this mystery, it would be a vain and fruitless

thing for me to try to throw additional light upon it. But, whatever our religious belief may be, and even if we have none, we cannot gainsay that, through mastery of pain and grief, man can pass to a fuller recognition of his own strength, which is something worth while.

We can also learn sympathy for others—a very Neptunian lesson.

Perhaps, too, we may discern that (to quote from MacDonald's *Phantastes*—a work as Neptunian as its name), "What we call evil is the only and best shape, which, for the person and his condition at the time, could be assumed by the best good."

ANSWERS TO PROBLEMS

VERNITA CHURCHILL, a member of the Committee of the Astrological Lodge of London, and a well-known lecturer on astrological subjects, has kindly agreed to answer questions concerning children, courtship, domestic, and psychological problems.

Every question must be accompanied by a coupon, which will be found on page 141, and a stamped addressed envelope must be enclosed for reply, in case there is no space to print it. Also please state the birth date of the person about whom the question is asked—day, year, place, and time, if possible. If the question concerns two people, such as husband and wife, dates of both must be given.

Please do not send questions concerning racing, health, or money affairs.

Examples of questions recently dealt with follow below.

BACKWARD CHILD.

I am worried about my son, aged 14. He is not really stupid, and yet he is always a long way behind his brothers at school, and he can never pass exams. Can I do anything to help him?

Your son is not at all stupid. He has a good brain and an intelligence above the average. But he is a Taurus child, and must be allowed to go his own pace and not be "bustled." These children always need time, and can seldom answer anything on the spur of the moment.

If he were told, when he was given the examination papers, that it did not matter how long he took to do them, he would

probably answer every question perfectly, but his brain is paralysed by the knowledge that it must be done in a certain time. Explain to him that it is far better to answer one question well than all of them indifferently. Let him read through the questions and choose which he likes best and answer that one quite regardless of time. Then let him do the same with the next, and not mind how many he leaves undone. This will destroy any sense of bustle, and he will be able to go ahead, and will quite probably finish the lot.

General intelligence questions try these children very much, not because they do not know the answers, but because they find it impossible to jump quickly from one subject to another.

Taurus children are slow, patient, and persevering, and nearly always succeed in life owing to their stability, perseverance, and determination.

BEST TIME TO PROPOSE.

I am in love, but do not like to propose because I am so afraid of rejection. Can you tell me the best time to do it?

The girl you love is a Cancerian, so the matter should be an easy one. Anything to do with home-making is irresistible to that type. Tell her that a friend of yours is getting married, and has asked you to choose some furniture, and will she help you do it. Then go with her to one of the big shops, and furnish a house in imagination. Particularly dwell upon the things for the kitchen.

Then, after you have given her some tea, you may propose with confidence.

If this should fail, however, delicately insinuate that you are being very neglected, either in your home or your lodgings—that your family do not understand you, and your health is suffering in consequence. This will bring out all the protective mother side, which is so strong in Cancerians.

If she will not have you after this, she will not have you at any price, and you are only wasting your time trying to make her.

DEPRESSION.

I suffer from terrible depression. I try to fight against it, but it gets me down every time. Is there anything I can do?

Depression is shown in the horoscope as an affliction between Saturn and the Moon, and therefore it has to do with the bony structure, ♄, and the emotions, ♀.

If you look at yourself in the glass, you will find that you stoop slightly, with your head bent forward. This must first be corrected. Stand up straight, shoulders well back, and chin tilted in the air. It will be difficult to remember at first, but tie something round your finger so that it will continually remind you.

You cannot be depressed if your spine is straight.

Now, on the emotional plane, depression is nearly always accompanied by a feeling of self-pity, and an absence of thanksgiving.

You are only pitying yourself, because you are unconsciously dwelling upon the sad and tiresome things of your life, instead of on the happy ones. You are failing to give thanks for those things which you do enjoy.

So every time you straighten your back, take a deep breath, and say "thank you" for something. It need not be to a God, if you do not believe in one, but just say "thank you." For the light, or the power of motion, or the gift of speech, or the beauty of the shadows—for the hundred and one things now you don't even see, because your mind is so filled with your troubles.

If you do this faithfully, you will find that the depression will fade like magic.

NOTE.—Readers availing themselves of Mrs. Churchill's advice are asked to state their willingness to allow data to be published, for the sake of other readers who might like to study cases and perhaps proffer further advice. Such willingness is, however, not essential.

THE MISSING BALL

A PROBLEM IN HORARY ASTROLOGY

By LUNA LEO

THE scene—and supper—is laid in a suburban dining-room. Mr. and Mrs. X are discussing their two dogs when Mr. X suggests it is time they were given a new rubber ball to play with, for they have chewed their old one into a shapeless mass. At this Mrs. X explains that two balls, one green and the other red, were bought at the same time about three months ago, but the red one was lost almost at once, and although search had since been made several times all over the house and garden it has not yet been found.

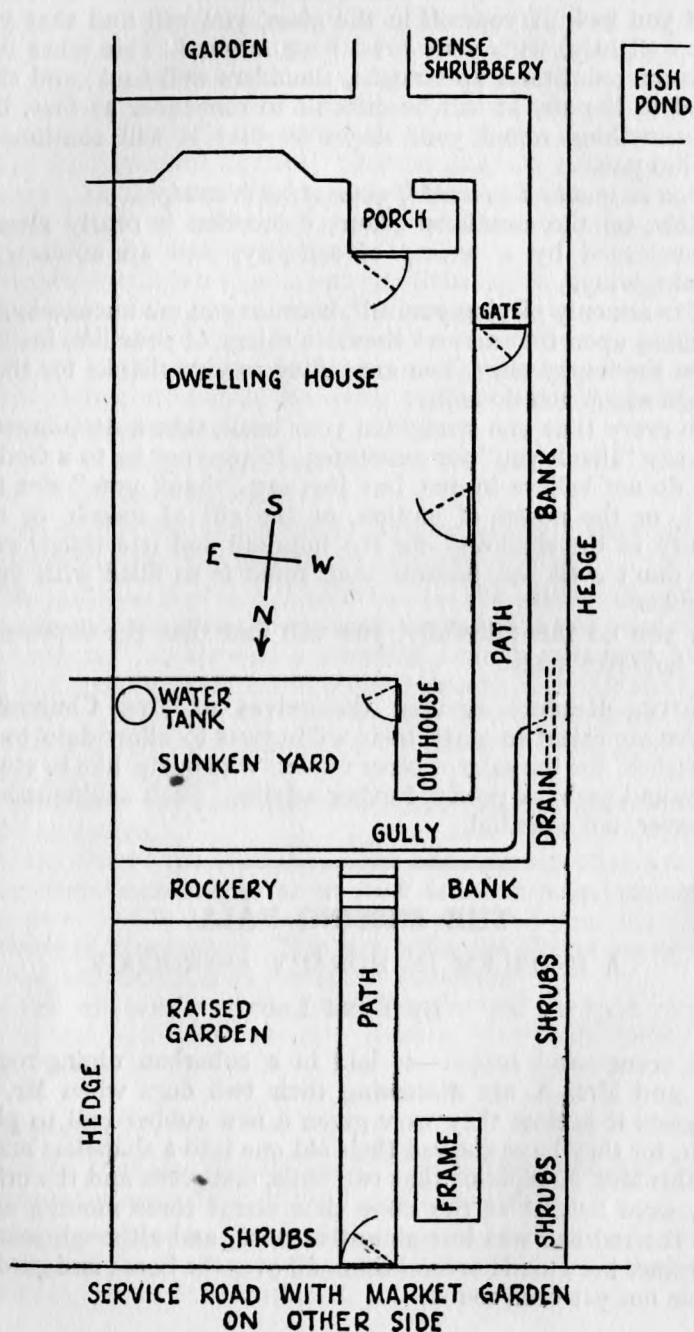

This is the first Mr. X has heard of the second ball, and he plies his wife with questions concerning possible hiding-places, most of which, however, she has examined. Then, although bedtime is near, he casts a horary figure, at which Mrs. X, being the sort of marriage partner every astrologer deserves, goes off to bed in disgust.

The map inspected, Mr. X takes an electric torch, and in barely a minute follows his wife to the bedroom with a smile on his face and the ball in his hand. "It's a trick! You knew where it was all the time," indignantly retorts Mrs. X, no other form of answer being deemed sufficiently expressive in the circumstances.

The ball is practically worthless, but as the map is particularly interesting as a horary figure, readers are invited to test their own skill in reading it, and to that end a plan of the premises is appended embodying the various likely places which, in addition to the usual indoor possibilities of an ordinary suburban dwelling-house, were all subjected to the original search, and a summary of the different questions put to Mrs. X is given below, together with her answers.

House—had been spring-cleaned and all furniture moved.

Water tank—inverted and empty.

North garden—dogs' playground, no need for search.

South garden—not free to dogs, and no search had been made.

Gully drain—inspected and poked. Would have been choked by ball.

Garden frame—full of boxes and pots. Believed to have been closed at the time.

Outhouse—full of tools and general odds and ends. Not thoroughly searched.

Bordering hedges—had been cut by neighbours, who would have returned ball if found.

Fish-pond—unlikely. Ball would have been seen if floating, but not if it had sunk.

Service road—casually examined at time.

Market-garden—doubtful.

The house itself covers all manner of possibilities, too numerous to mention, but as the horary map is so definite in its indications that Mr. X, ignoring all wifely protestations, went straight to the spot as soon as it was cast, the matter must now be left to the judgment of those anxious to tackle the problem.

The data are 10.13 p.m. British summer time, June 22, 1937, London, and the solution will appear in the next issue.

MISCELLANEA

THE SIBERIAN METEORITE

IN *The Universe in Space and Time* by Prof. Van Den Bergh, recently published and reviewed in the Quarterly, mention is made of the vast meteorite that fell in Siberia, at about 60° N. lat., 101 E. long. It occurred in the early morning of June 30, 1908, and he speaks of it as "the greatest cosmic catastrophe that has ever happened to the earth in historic times."

The exact dimensions are not known, as it penetrated deep into the ground, and the fragments could not be found. It left numerous craters, the centre of a totally devastated region of about 450 square miles. It burnt away the trees, and killed thousands of reindeer. As it was a desolate region, it is uncertain whether any human beings were killed. If the meteorite had fallen on a town like London or Paris, it would most likely have completely destroyed it, with the loss of millions of lives.

The author mentions the strange light he saw in the sky on June 30th and July 1st, after sunset, which he considers was due to the meteorite leaving a trail of cosmic matter very high up in the atmosphere (reflecting the sunlight), and which had travelled over from Siberia to Europe.

I wrote to Prof. Van Den Bergh to ascertain the time, and he kindly replied that "the Siberian meteorite hit the Earth at sixteen minutes past midnight Greenwich mean time."

The sign Ω rises (denoting something on a big scale), with Υ just above the ascendant, near Ω 15—said to be a degree of "explosions, noises." It is noteworthy that the nadir and M.C. are in exact \square aspect to \mathfrak{J} , to which the \mathfrak{D} applies by a close conjunction, in the 12th house. ϖ 24 and 25 are said to be degrees of "darkness," "obstruction."

There is much strain and stress here from the heavy afflictions in cardinal signs, the large group of planets in ϖ being \mathfrak{J} \mathfrak{H} and \square \mathfrak{h} .

The ruler \odot in a \mathfrak{D} sign applies to \square \mathfrak{h} in a \mathfrak{J} sign, and to δ Ψ , \mathfrak{F} , \mathfrak{J} \mathfrak{H} . The retrograde \mathfrak{F} , almost exact \mathfrak{J} \mathfrak{H} , denotes swift, unexpected disaster from the air.

Pluto, in a Mercurial sign, is in close aspect with the nadir—that may point to the meteorite burying itself deep in the earth. (It is also in close aspect with \mathfrak{J} and the M.C.)

\mathfrak{J} denotes the heat and iron of the meteorite, and afflicts ϖ , the natural 4th-house ruler. The adverse \mathfrak{h} , \mathfrak{H} aspects signify the weight and unexpected nature of the catastrophe,

\mathfrak{H} (in a \mathfrak{h} sign) certainly afflicts every planet in the figure.

and is in close parallel of declination with ♄, ☉ and ♃—parallel ♄ being exact.

The benefic ♃ rising (ruler of 8th) may account for the saving of human life.

At the time of the New Moon just before (a Solar eclipse) on June 28th, in ☾ 6.31, Pluto is on the nadir—4.31 p.m. G.M.T., 11.12 p.m. local.

Possibly Siberia is ruled by Pluto or Saturn.

Earlier in June, when ☉ was ♄ PL, ♄ was ♄ ☿ ♀ ♄, and ♃ is in adverse aspect with all planets.

The meteorite fell at 0.16 a.m. G.M.T.—7 a.m. local time.

X	XI	XII	I	II	III
☿	♄	☾	♄	♄	♄
24.46	9	20	18.37	3	23
☉ ☾	♃ ☾	☿ ☾	♀ ☾	♂ ☾	
7.47	22.33	15.22 R	17.20	24.47	
♃ ♄	♂ ☿	♄ ♀	♄ ☾	PL ♄	
14.10	9.46	15.13 R	14.20	24.35	
♄ ☾					
4.54					

Contributed by M. Matthews

GEN. FRANCO'S PRE-NATAL EPOCH

X	XI	XII	I	II	III
☾	♄	♄	♂	♂	☾
5½	3	25	14	18	29
☉ ☿	♃ ♄	☿ ☿	♀ ♄	♂ ♀	
26.55	5.5	7.21	7.59	1.59	
♃ ☿	♂ ♄	♄ ♄	♄ ♄	PL ♄	
0.1	26.47 R	5.30 R	6.30	6.55	
♄ ♄					
19.51					

Mars is strongly in evidence in Gen. Franco's epoch, giving a warlike disposition. The planet rises in ♀, square ruler ♃, ☿, ☉, and ♂—♄ ♄ in a Martial sign, * ♄, ♀ ♄.

Contributed by M. Matthews.

DATA OF FAMILY OF DEAF MUTES ALL BORN IN HALIFAX

Father—H. R. July 10, 1881. Time unknown.

Mother—A. R. September 2, 1890. Time unknown.

Son—Harry R., Jr. July 10, 1914. Afternoon (about 3 p.m.).

Daughter—Mabel R. March 11, 1918. Morning (3 a.m.).

All born deaf and dumb.

Father and mother married May 7, 1913.

Parents both well built, strong-bodied folk. Children slim and active. Boy fair, girl dark. Both seem Π type, particularly the girl.

Contributed by a Subscriber.

ASTROLOGICAL CONGRESS IN PARIS, 1937

FROM July 17th to 25th an International Congress of Scientific Astrology, under the auspices of the Astrological Society of France, was held in Paris. This was the fourth Congress of its kind, two others having been organised at Wiesbaden in 1928 and in Dusseldorf in 1936 by Dr. Korsch, and another in Brussels in 1935 by M. Brahy. Dr. Korsch and certain other German astrologers were unfortunately not able to attend the Paris Congress; there were, however, representatives from eighteen different nations, and the small Studio des Champs-Élysées was packed all day to hear the large number—perhaps the excessive number—of lectures.

Each of the five days of the Congress was devoted to different aspects of the Science: on Monday, July 19th, after the formal opening of the Congress by the Vice-President of the Société Astrologique, talks were given on astrology in its relation to world affairs; on Tuesday speakers from Austria, Belgium, England, and France lectured on different methods of interpreting planetary influences; on Wednesday papers were read on medical astrology; Thursday was occupied by subjects of a varied nature, and Friday by the study of directions and transits.

On the evening of Wednesday a banquet was held in the *Exposition* grounds, near the Place de la Concorde; over seventy delegates and students were present. Other activities had also been arranged, the most outstanding of these being a visit to the Planetarium, where the movements of the heavenly bodies were depicted in a manner which proved instructive and useful. The absence of Dr. Korsch prevented any immediate plans being made for further developments of Astrology on an international scale, but it was suggested that a fifth Congress be held in London in 1939.

The Astrological Lodge was represented by the present writer.

A. SUDBURY HURREN.

THE TRAGEDY OF THE "POCKET CHANCELLOR"

By MABEL BAUDOT

THE very name of Engelbert Dollfuss, known familiarly as the "Little Chancellor" of Austria, arouses a feeling of pathos and compassion.

His life was comparatively a short one, as he had not attained his forty-second birthday when his assassination took place, yet into this brief span he crowded so much nervous energy, financial acumen, and political ability that his history was as mutable and kaleidoscopic as if he had long passed the Psalmist's three score years and ten.

Born at Texing, Lower Austria, on October 4, 1892, he had

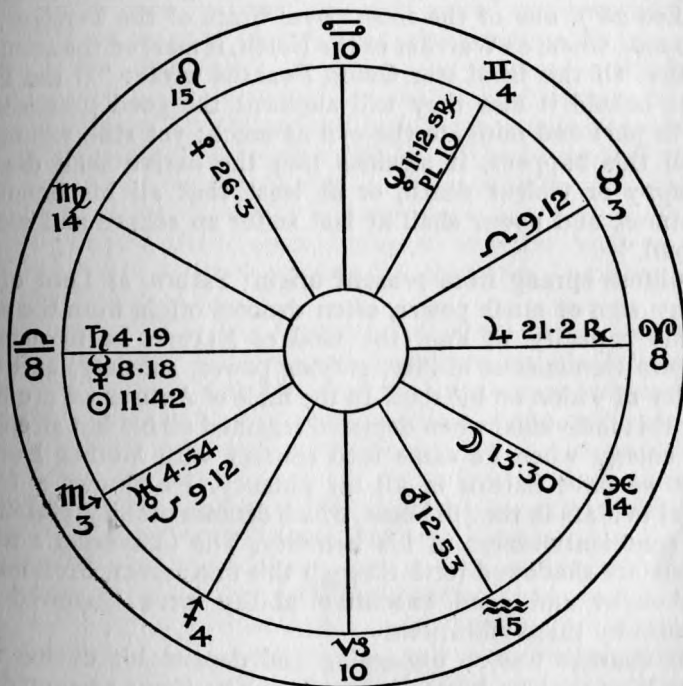

Libra rising, strongly tenanted. The sign of the Balance is very fitting in one who did his best to maintain harmony and equipoise in the clashing discords and well-nigh inextricable difficulties of post-war Austria.

It is noteworthy that Libra, in close connection with Saturn,

can be a sign of infinite tragedy, in spite of its Venusian traditions and rulership. The dark-ringed planet is in his exaltation here, where he exercises the maximum of his power, and the soul is heavily tested by the Reaper when it incarnates under the double influence of the 7th sign and the ruler of Capricorn, which zone is in square to Libra in the zodiac.

Dollfuss was an inch under five feet in height.

The Chancellor's 1st house is filled with planetary influences as the Sun and Mercury also play out their vibrations in Libra. Venus is well placed in Leo where character is concerned, introducing warm-heartedness and magnanimity, and bestowing the large views and tendency to see everything *en grand* which is such a salient trait of the Lion. She is elevated and in a favourable house, but is in semi-square to the rising degree, and, still more disquietingly, is only two degrees from Regulus (in Leo 28°), one of the four Royal Stars of the Persians, in 3000 B.C., when, as Watcher of the North, it marked the summer solstice. Of this fixed star Guido Bonatus wrote: "If the Fortunes behold it also they will augment the good promised a fourth part and mitigate the evil as much; yet still, whatever of all this happens, it signifies that the native shall die an unhappy or violent death, or at least that all his honours, greatness, and power shall at last suffer an eclipse and set in a cloud."

Dollfuss sprang from peasant origin; Saturn, as Lord of an earthy sign of much power, often denotes origin from the soil. In his capacity of Pan, the God of Nature, he frequently bestows tremendous ability, staying power, subtlety, and the faculty of vision on his sons. In the fable of Antæus we are told that this individual when depleted regained all his lost strength and energy when he came into contact with Mother Earth. Here we have Saturn in all his potency. He throws a trine aspect to Mars in the 4th house, which denotes probity, stability, and conscientiousness in his heredity. The Chancellor's forefathers are shadowed forth through this fine aspect. Profundity of thought and good executive ability were bestowed on Dollfuss by these vibrations.

His courage was so unflagging and dependable during the Great War that he became conspicuous and was promoted to the rank of lieutenant for his valour on the Italian front with the Austrian Army. Mars well configured with Saturn gives much bravery and power of organisation.

Uranus in Scorpio is also a daring influence, and adds profundity to its innate swiftness and progressiveness. The planet is in the 2nd house—one of the occupational ones,

showing that soldiering came to him without overmuch effort. Uranus is in exact semi-sextile to Saturn. This is a vibration which, although not very strong in itself at birth, can be used as a bridge to lead to the desired destination. It is a very useful link.

When the War ended, Dollfuss studied law and economics in Vienna and Berlin. Libra is well suited for legal studies, and Mercury, rising before the Sun, evidently caused him to feel much interest in jurisprudence. This talent is enhanced by the mental planet applying closely to a trine of Mars—brilliancy and a keen prehensile mind accrue from this aspect, with quick and apt decisions. As for economics, this subject can be studied with much aptitude and depth when Uranus is in the house of financial affairs. The Scorpionic setting gives this body less suddenness and more concentration and stability on account of the fixity of its nature. Dollfuss soon gained the reputation of being the leading authority on Agriculture, and was invited to take Cabinet office as Minister of this science. Agriculture comes to some extent under Venus, in her capacity of ruler over the earthy and bountiful sign of Taurus, and this planet has a preponderating influence as sovereign of the Chancellor's horoscope.

His political ability soon became so manifest, however, that he was called upon to succeed his chief, Dr. Buresch, in the Chancellorship of Austria.

He took office in May 1932, when the outlook for his country was one of great darkness and pessimism, for the fair land of the Blue Danube was ploughed up by continual strife, internecine warfare, and dangerous political storm and stress. In Dr. Dollfuss's progressed map the Sun was in the 20th degree of Scorpio; his Moon in Leo 26°, on the natal Venus, therefore also in the perilous zone of Regulus, with his ruler. Saturn was barely a degree past the natal Mercury, being in Libra 9° at this date. The progressed Venus, having sped forward with great swiftness, was in Libra 10°, in sextile to progressed Mercury in Sagittarius 9°. Saturn, of course, having just passed the radical degree on the ascendant, indicated the responsibility of such a position in the State, and some of the other aspects seem fairly promising. His policy was to endeavour to steer Austria to safety by employing all the forces which he found to be anti-Nazi and anti-Socialist. Just after the War, in 1919, Austria and Germany had been prevented from coming together by the strong opposition of the other European Powers, and when the world depression was at its height in 1931, Austria again looked towards Germany; but with the advent of Hitler

to supreme power there was a *volte face* of the former country, which was beginning to dread the Nazi régime, and so felt most adverse to any incorporation with Germany. When Dollfuss took the Chancellorship he saw that it was imperative for him to choose a powerful ally. With the Sun rising in his chart, he naturally turned to a Sun-ruled country, and his choice fell upon Italy under the rays of Leo and the solar luminary. He felt sure, with the prevision bestowed by two transcendentals, Neptune and Pluto, in close conjunction in the prophetic 9th house, that Mussolini would offer his potent protection against the swallowing of Austria by the Nazis. Venus in Leo is most significant.

The Little Chancellor was in great danger, even within the precincts of his own Venus-ruled Vienna. In October 1933 the feeling among the Nazis intensified, and an attempt was made upon his life by a young man who approached him, and, feigning to deliver some letters, drew a small pearl-handled revolver, and fired two shots. "I have been hit!" cried Dollfuss, flinging open his coat; his linen was stained with blood. One of the shots had entered his chest two inches above the heart. It had been deflected by a waistcoat button, to which the Chancellor owed his life. The natal square of Mars and Uranus had been inflamed by the opposition of the progressed Moon, which in this month was in Virgo 12°, in opposition to the natal Moon in Pisces, and inconjunct Mars. There is no doubt that the beautiful natal trine of Venus to Jupiter acted in all its strength as a preserving influence on this occasion. It is interesting to note that silver buttons—adornment—come under Venus. To this aspect the Chancellor also owed his kindness of heart, mellow disposition, and the friendly outlook which endeared him to all who knew him well.

But from this time onwards peril surrounded him almost unceasingly. Fate and foes alike can be of catastrophic import when Saturn lies in ambush in the 12th house—and in the sign of his greatest power!

A few months later his position in the Chamber became so untenable that he proffered his resignation, but President Miklen would not permit this step, and begged him to retain office, which he did with the utmost reluctance. Dollfuss found that he had to resort to expedient. Libra shines at employing tactful and diplomatic measures, and can be exceedingly subtle on occasions, as this sign invariably seeks to balance all situations and to reconcile conflicting ideas. Its ideal is to merge all discord into a harmonious whole—if possible.

The Chancellor announced: "We will build up a Catholic

German State, which will be thoroughly Austrian upon a corporative (Fascist) basis. It will be an authoritarian State formed on occupational lines."

The Piscean Moon is a believer in unity, and is also a religious influence in most cases. Dollfuss was an ardent Catholic, practising his faith devotedly in everyday life. The conjunction of the super-planets, Neptune and Pluto, in near neighbourhood in Gemini in the 9th house, also instilled a strong religious tendency.

In 1934, affairs became more and more menacing—the internal discords still more clashing. The Heimwehr troops belonging to the Austrian Government showed signs of great activity. They reported a Socialist coup to be imminent, and carried out searches of Socialist headquarters. The final coming-to-grips was foreshadowed by Major Fey, Vice-Chancellor and Austria's strong man. He addressed his Heimwehr troops on February 11th: "To-morrow we are going to clean up Austria!"

The Socialists tried to bring about a national stoppage of work. They put the Viennese power stations out of action, entrenched themselves within their strongholds of the municipal flats, and showed themselves as formidable and determined enemies. For four awful days Vienna ran with blood, and internecine warfare blazed its hellish trail through Austria. Prince Starhemberg, the Heimwehr leader, took control of affairs, and repeatedly urged forceful measures upon the reluctant Chancellor. At last, filled with foreboding and horror, Dollfuss permitted the warrior Starhemberg to have his way—the old story of Venus ceding to Mars—and the Socialist revolt was stamped out. Before the firing was over, Prince Starhemberg announced that the Fascist State was born. For the first and last time, the Pocket Chancellor, in his dire perplexity, had allowed the weapons of ruthlessness to be employed. His ruler, the Libran Sun and Mercury, the trine between the benevolent Jupiter and Venus, the Moon in the compassionate sign of Pisces, are *all* factors normally averse to bloodshed and ruthlessness. Many of his planets receive particularly harmonious vibrations—a large number are in humane signs. The only element which drove him to employ violence is the square of Mars to Uranus—they are only just within orbs of a square, and the pressure put upon him was overwhelming. At this juncture the unhappy man might almost have used the words of one of Shakespeare's unfortunate characters—

My good stars, that were my former guides,
Have empty left their orbs and shot their fires
Into the abysm of hell!

He knew in his own soul that the driving out of Beelzebub by Beelzebub is never successful, but on this occasion Uranus lashed out from the dominion of death and destruction, to Mars in the electric Uranian sign. Unfavourable aspects from fixed zones are always difficult to deal with, especially when the state the subject is governing is given over to a temporary re-enactment of the Dark Ages.

Dollfuss found by the summer of 1934 that he must either stem the prairie fire of terrorism which was blazing through Austria or be destroyed by it himself. Threatening letters, menaces of assassination, reached him by every post. Note his weak Moon, in the poignant Pisces, in evil vibration to the Neptunian-Plutonian combination in the 9th.

And his own environment was the most perilous of all. His 4th house is held by Capricorn, the Lord of which sign throws a deep shadow over his ascendant. Verily, a man's foes are those of his own household! July became tense with intrigue. The Nazis determined to strike in order to save their comrades in prison or awaiting trial by the Austrian Government. A complicated plot was hatched, replete with all the equipment of international spy drama, worthy of a super detective film—secret orders, whispered messages, meetings in dark disused houses, pledges of secrecy, and the intangible aura of peril over all.

Dollfuss suspected the Socialists more than the Nazis, and a large haul was made of the remaining agitators of the Left. Then a big consignment of explosives from Germany was captured. This was an unmistakable sign that the Nazis were about to make a formidable bid for power. All this treachery, these ambushes, plots, and counter-plots are denoted in the Chancellor's life by Saturn in the 12th, so strongly tracking the rising degree.

On the morning of July 25th, Dollfuss was in the Chancellery, and received the first intimation of danger by hearing the sound of armed men in the corridor. His doorkeeper had heard alarming shouts of "Hands up!" He had torn off to find his master, who was unarmed, and rushed Dollfuss through the rooms to the celebrated Congress Hall—the hall of eight doors, originally constructed so that the eight Powers attending the Congress of Vienna should not be troubled over claims of precedence. Just as the Chancellor and his servant were on the point of leaving, one of the doors burst open and a party of desperate conspirators flung themselves into the hall. One of these desperadoes covered Dollfuss with his revolver and discharged two shots. As he was only five yards away the shots could scarcely fail to reach their billet.

The Chancellor reeled and fell. It is said that there was a loud crack as his head struck the floor. His assailants then asked him if he were severely hurt. "I do not know," replied the wounded man. They told him to stand up, but he could not walk. He was led to a sofa and an examination was made which proved that both bullets had struck him. There was a deep gash in the throat, from which blood began to pour. Taurus rules this organ, and is on the cusp of the 8th, and is disposed of by the Chancellor's ruler, Venus. Dollfuss asked for a doctor, but no physician was called. He then implored his Nazis captors to bring him a priest—this request was also refused. Major Fey was at last brought to the Hall, and the Chancellor's last words were addressed to him. "I resign," he said, "in order that there may be peace. Rintelen shall take command. I believe that bloodshed in Austria can be avoided."

Major Fey was then ordered from the hall; he had tried to press the hand of his dying chief before the Nazis hurried him away.

The drama in the Congress Hall had reached its last act. "I only wish for peace! May God forgive the others!" he said as he relapsed into final unconsciousness.

Peace—a Venus wish. Forgiveness!—a Venus prayer. Here the beautiful sign under whose aegis the Little Chancellor was born showed itself in all its aspiration for harmony. Under forty-two years of age, without the human aid of a physician, without the last consolation of a priest, with many of his high ideals unrealised, Engelbert Dollfuss could yet give utterance in the face of death, surrounded by his enemies, to the noblest prayer in the world—the prayer of forgiveness!

At the time of death, his progressed map shows chaotic and menacing aspects. His Sun was in Scorpio 23°, coming slowly to the square of the natal Venus. Saturn had just passed over his natal Mercury, and was in Libra 9°, between that planet and the radical Sun. Venus herself had reached Libra 13°, in exact inconjunct to the Piscean Moon, while Mercury was in Sagittarius 12°, in square to the Moon. The most salient position of all was that of the lunar orb. In July 1934 it had *exactly* reached the natal Saturn in his lions' den of the 12th house, demonstrating once more the truth of sidereal science—for this planet rules the 4th house—the end of earthly things. Libra is a sign which, if at all unfavourably aspected or tenanted, is peculiarly susceptible to wounds from human hands, and the eighth degrees of Libra and Aries are particularly dangerous ones.

Thus passed Engelbert Dollfuss by successive steps—honest

peasant married to a peasant girl, father of two beloved children, brave soldier, brilliant economist, wise minister, mystic, and idealist.

In his case, at least the good is not interred with his bones, for whenever the name of the Little Chancellor of Austria is mentioned, the peoples of all nations are ready to pay silent homage to the man who died for his country and his ideals.

LETTERS TO THE EDITOR

SOLUTION OF A PROBLEM

From R. S. GLEADOW.

In your issue of June 1936 you published an article by Mr. George H. Bailey entitled "Per Ardua ad Astra," in which was given the horoscope of a boy killed in a cycling accident. Mr. Bailey pointed out that the native had survived many very dangerous directions, and enquired how any astrologer could have foretold the date of death without considering the fixed stars. Correspondence followed, and so many attempts were made to explain the case that at last I turned my attention to it and found a perfectly reasonable explanation which perhaps you will allow me somewhat tardily to lay before your readers.

By symbolic directions the native had certainly passed through many dangerous afflictions; but not being a user of symbolic directions I cannot offer to solve that problem for the symbolists. The methods I propose to apply are those that were used with so much success by such men as Gauricus and Morin, namely primary directions, the solar revolution, and transits, to which Kepler added the progressions. It is unfortunate that there is at present only one work which adequately explains the solar revolution, namely, von Kloeckler's *Solarhoroskop, Transite, und aktuelle Konstellationen*, which has not yet been translated. But with regard to primaries, although not a good mathematician I was able to calculate all the relevant directions in this horoscope, direct and converse, in less than an hour, thanks to M. H.-J. Gouchon's recently published tables. Further, it has recently been shown on the continent that primaries should be calculated according to the Regiomontanus-Campanus method, and not according to Placidus. I have no wish to champion any system of house-division against any other, but in this case it seems as though only Regio (the method used by Morin) can provide the explanation.

Death will result from any direction of the significators of life (ascendant, Sun, Ruler, Moon) to the significators of death (Mars, Saturn, and any planet ruling or occupying the 8th house). In this chart, if we look for such an aspect falling due about the nineteenth

year we find one only—ascendant $\square \text{♂}$ ruler of 8th. This entails a rectification of 8 minutes, but since the birthtime is only approximately stated 8 minutes is quite within permissible limits. The ascendant will, it is true, have passed the squares of ♄ and ♅ , but neither of these planets is determined on the 8th house. The aspects $\text{♄} \text{♂} \text{♂}$, $\text{♄} \text{♂} \odot$, $\text{♄} \text{♂}$ ruler will have occurred in childhood, but death was not to be expected so early, because of the protection afforded by ♁ elevated in sextile to the ascendant.

By the method of Campanus this argument is impossible; for since Mars does not rule the 8th his square to the ascendant is no more dangerous than that of Uranus or Neptune. The problem would have to be explained in some other way. Besides, Campanus does not appear to explain why the accident should have happened on a short journey; but by Regio Mars ruler of the 8th is also ruler of the 3rd, and so everything is clear.

The only planet tending to preserve life was Jupiter (by his sextile to the ascendant). He was unable to do so because he too was attacked by the significator of death. At the time of the accident Mars was directed to the opposition of Jupiter; and the importance of this aspect was much enhanced by the fact that the mid-heaven of the solar revolution fell on the directional Mars and in opposition to the radical Jupiter; and further that Jupiter in the revolution was angular and exactly squared by Mars from the radical 8th, squared also by Saturn ruler of the revolutionary 8th. The radical significators of life were all afflicted in the revolution. Finally, the event happened when Uranus was stationary in opposition to the Sun, and Mars at the same time stationary in the radical 8th in square to Jupiter and to the meridian of the revolution.

Thus we see that this horoscope, far from being exceptional, exemplifies perfectly the rules followed by Morin. The native died under the direction of the chief significator of life to the significator of death; the only planet capable of preserving life was prevented from doing so; the comparison of the solar revolution to the natus showed serious and characteristic afflictions which accorded with the directions; the event was timed by the transits; and the last new moon before death fell out in 11° Sagittarius, forming a grand square with the ascendant (13° Gemini), Moon, and Venus (radical ruler) of the revolution. Finally, the directional ascendant had come to the bodily opposition of the very malevolent fixed star Scheat.

From GEORGE H. BAILEY.

Now that you, our beloved Editor, have joined issue with me in this matter and challenge conversion from the example chosen, I cannot do other than take up the points you have raised, trusting those readers with no interest in symbolics will not begrudge the space devoted to this question, which vitally concerns the future of astrology.

It seems that my efforts to introduce a new breed of symbolic measures are likely to be wasted, for the number the stricter

symbologists are permitted to employ is severely limited, yet I fear the use of Campanian cusps will not be welcomed by most symbologists, despite your exhibition of correct cuspal calculations (necessary when measures are few), which, my dear Editor, as you anticipated, have quite effectively stopped me from calling you a Dutchman!

The implications behind these calculations, however, are so trivial (even to the point of absurdity), that common sense demands a repetition of your statement that they constitute "a most perfect example of the value of symbolics" (although *not* in the sense originally intended), for while it is all too easy to produce such examples after an event, they are utterly worthless for *predictive* purposes.

But let us examine the case still further in the light of the few measures advocated. You say that "the two radical contacts pointing to the tragic death of the native are ♀ □ ☿ and ♀ □ PL □," and "it is rational to suppose that one, or both, would be in action at the time of death." In the face of this it is perhaps pertinent to enquire why the lad was not killed at about the age of $4\frac{1}{2}$ years, *when Saturn was squaring Pluto by that "background" measure of $\frac{1}{4}^\circ$ per annum, for then, by 1° , "the M.C. was exceedingly close to the opposition of Uranus and square of Mercury"* (or call me a Dutchman!).

What is more, at that time, by 1° , Venus ruler of the 8th was near the square of the M.C., and was also involved with the Sun in the opposition from Saturn, ruler of the 4th (end of life), while the Moon had moved close to the conjunction of Saturn, and Neptune was about a degree past the opposition of Mars. Jupiter, too, ruler of the 3rd, had reached the midpoint of the square between the Sun and Pluto, and the 8th cusp was semisquaring the midpoint of the opposition between the Sun and Saturn.

Such a convergence of directions between the bodies and cusps most concerned with the death of the native is surely a much more potent affair than the two put forward by you, dear Editor, so much so that in this case alone (and I can produce many more examples) grave errors would have arisen had predictions by symbolic methods been attempted at the birth of the native.

I may add that having lived next door to the lad for many years I can confidently assert that until he met his death he had come to no serious harm.

In conclusion, I would like to address a plea to those who still resolutely swear by symbolics, and that is to make no further attempts to fit them to past events, but apply them to predictions only, using the horoscopes of acquaintances and writing out forecasts in detail for a few years in advance. By so doing, what is lost in astrological reputation will be gained in astrological experience.

EDITOR'S REPLY.—Deeply touched as I am by the affectionate language used by Mr. George H. Bailey, I am not so "touched" (in another sense) as to be deluded by his arguments.

Mr. Bailey says it is "all too easy to produce such examples after the event." But who produced the example of the lad who was killed by a lorry in order to demonstrate the use of the stars in directions?

When has Mr. Bailey tried to "write out forecasts in detail" by means of the fixed stars?

But to imply that symbologists do not do so seems strange indeed, seeing that several of the most ardent users of fixed measures are professional astrologers, who presumable are constantly "writing out forecasts in detail for a few years in advance."

It is said by Mr. Bailey that the lad ought to have been killed at $4\frac{1}{2}$ years because of the directions then operative. It is surely widely held that one cannot judge the directions of an infant as if they were those of an adult. Why was I not killed (or my father ruined, if one refers such directions to the parents) when, at about the same age, I had M.C. conjunction Saturn converse? My Saturn is badly enough afflicted, yet nothing happened.

I do not claim perfection for symbolic measures—very far from it—but I do claim that the ordinary progressed horoscope, considered as a complete system, is *beneath contempt and much worse than useless*.

Hence I say that those who try to find something more reliable are committing no crime.

I shall unhesitatingly throw over symbolic measures if and when I find "a better 'ole" to which to betake myself.

From S. L. MACBEAN.

Mr. G. H. Bailey seems to be impervious to the spirit of symbolism which permeates the whole of astrology. A day for a year as a measure of time is purely symbolic, and the day which is used is a "mean day," which has no actual astronomical counterpart. The zodiac does not stand alone as an isolated phenomenon. There could be no zodiac without our earth's equatorial plane which marks the starting-point of the zodiac at each vernal ingress. In fact the equator is the terrestrial analogue of the celestial ecliptic.

If one revolution of our earth about its axis corresponds to one revolution of the earth about the Sun as a time measure, it is obviously immaterial that the earth's path is not a perfect circle. The earth's axial revolution is absolutely regular and never varies, which fact is warrant enough for the uniform progression of symbolic measures.

The slight irregularity in the Sun's motion is representative of the approximate nature of the time measures of symbolic arcs. No one claims these measures to be exact in themselves as to time, though they frequently are. But by taking the mean of several such measures we generally come very close to exactitude.

Notwithstanding Mr. Bailey's effort to show that the fixed-star influences are not so numerous as they may seem to be, he admits

there are 116 areas of such influences around the zodiac so that my use of the word "accommodating" is still justified.

Apparently the stars in each group are all of a similar nature, and all are evil—another accommodating fact! What a prospect!

If the orb of influence of any body is a measure of its power, then the allowable orb of one degree or less for the stars shows how feeble they must be. And if one degree is all that is permissible for the radical positions the orb for the progressed positions would be probably six or seven times less, so it is not surprising that such influences are to be admitted only when the angles are involved. This is whittling things down to a very fine point.

Mr. Bailey ought in fairness to inform us how he figures out a minimum of 720 arcs for symbolic measures. Taking the map of Mrs. Warfield as given in the June issue, Mr. Bray makes out six major arcs by the radix system. By one-eighth measure there are about seven directions; by the quarter measure nine directions, including the angles, fortuna, and the node, or about twenty-two in all. Even if we add the 4/7 rate there are only nine more. So that Mr. Bailey's figures are simply fantastic.

Mr. Bailey's claim that any success in the use of symbolic measures is due to coincidence in view of "this welter of possibilities" is preposterous. In the map just mentioned how would it be possible for the $\frac{1}{8}^\circ$, $\frac{1}{4}^\circ$, $\frac{1}{2}^\circ$ and $59' 8''$ measures to *all* point in the *same* direction were it not that there is a wonderful principle co-ordinating them all? For simple coincidence to produce such a consistent array of influences in the multitude of events investigated by symbologists is a mathematical absurdity.

Mr. Bailey brings out the fact that there are similar distances between several of the bodies in the map of the cycle accident case. His $40/77^\circ$ measure brings $\text{♂} \text{♂} \text{♀}$, $\text{♀} \square \text{♂}$, and $\text{♀} \square \text{♁}$. This measure means nothing except that it shows a radical space relationship between $\text{♂} \text{♀}$, $\text{♀} \text{♂}$, and $\text{♀} \text{♁}$.

My experiments tend to show that such space relationships have a paralleling effect on the bodies involved, just as they do when the angles are concerned.

GEN. FRANCO

From (Miss) M. MATTHEWS.

It seems that Mr. Sampson's evident Fascist sympathies blind him to the truth about Gen. Franco. Instead of the kindly, generous, sympathetic being that he creates from his imagination, he would, if he had carefully followed the events in the Spanish civil war, form a very different opinion. To attack your own countrymen because you do not like their form of government, and brutally destroy them, is not exactly *kind* and *generous*.

Mr. Sampson says, "Whatever the unfavourable incidents or accidents attributable to the square of Mars, the favourable aspects of Saturn and Jupiter to both luminaries are of prime importance."

Surely, as the ☉ and ♃ both *first* apply to the squares of ♄, the *ruler*, these aspects are of prime importance. ♃ is not very powerful for good in this horoscope, as it is weak by house, retrograde, in a Martial sign, and ♄ an elevated ♃, giving hardness and ambition—the ♄ being made worse by the rulers of ♈ and ♎ being badly placed and aspected. ♀ gives but little help here to soften the character, being greatly vitiated in ♎, ♄ ♈ and ♎. The ascendant, ♎, *can* be more ruthless and destructive than any sign, and ruler ♄ is in the ♎ navamsa—the progressed ♄ being in ♈, ♄ ♃, from the angles of the progressed figure. This latter aspect seems to have chief rule at present.

We have some freedom as to whether we follow the best or worst tendencies in our maps. Certainly Franco has some good birth aspects; but when one thinks of the incalculable human suffering he has caused, one knows that he has failed to live up to the better side of his nativity.

A TASK FOR THE EDITOR

To C. E. O. CARTER, ESQ.

BOMBAY PRESIDENCY, INDIA

D/12-4-37.

DEAR SIR:—One of our friends is said to have been born on 1-7-1891 at about 6.20 p.m. or a.m. according to the one version and according to the other version he is said to have been born on 25-8-1893 exact or true birth date with exact birthtime of the said gentleman is not known. The time of writing this letter for enquiring predictions regarding him is 4.15. p.m. of to-day's date. Will you please therefore send us free and free of charge trial reading of astrological predictions regarding all matters and if he is convinced, we will send for complete life reading. Without having free trial reading, one cannot decide whether it would pay him to have complete astrological life reading. Please let us know your most lowest charge for complete life reading on all subjects. Please let us know as many fullest postal addresses as possible of the most expert astrologers astrologers' associations and astrological lodges and conventions of United Kingdom, Europe, France, Germany etc.

Thanking you in anticipation of hearing from you most frankly and fully and begging to be pardoned for the trouble and awaiting the pleasure of increasing your income by introducing as many friends as possible.

Wishing you all good luck and prosperity.

We are Dear Sirs, yours faithfully:

&c.

P.S.—Will you please let us know whether any book as been published by any expert astrologer or association from which one can know that such and such would be the rate of forward cotton prices on such and such day and such and such number of such

and such lottery on such and such date would draw the first prize and what is the lucky number for such and such man on such and such date, if so please let us know the name and fullest title of the said book with author's name and with fullest address of the publishers and the price of the book.

DIGNITIES AND DEBILITIES

From JOHN BURNET.

There are one or two points which puzzle me in my studies, and one is in regard to aspects. I wonder if you can solve the mystery. Mr. E. H. Bailey has laid it down in his magazine that squares and oppositions and such were not always evil, but sometimes good; and *vice versa* with so-called good aspects. You have said yourself that the planets' positions by sign had more to do with the aspect than their distance apart. Mr. Bailey points out that the chief thing to be considered is the dignity of the applying planet. Now, the bit that puzzles me is, what about the planet that is being applied to by aspect? What if it is debilitated by detriment or fall; for example, ♃ in 8 12° ✕ ♄ 17°, would this be put down as harmonious or discordant? Another thing, occasionally we have two planets both in equal degrees, one dignified and the other debilitated, viz. ☉ in ♍ 4° ☐ 2↓ in ♏ 4°; will this be harmonious or discordant? And very often the separating planet is debilitated or dignified, viz.—♂ in ♏ 17° ✕ ♀ 14°, is this harmonious or discordant? I would be very glad to have these matters cleared up, and hope you will understand what is puzzling me.

By the way, is there any chance that by joining the Astrological Lodge as a provincial member I could get lessons or instruction, which would be paid for; also books from the library for study, expenses of which I would pay for, and if possible printed lectures. If you think that I would benefit by provincial membership I will get in touch with Mrs. Hurren without delay. There is no Lodge or society up here, and if it were not for your magazine and others I should be absolutely out of it.

NOTE.—“Country Members” of the Lodge are entitled to receive books and lectures on payment of postage expenses, and any difficulties will be explained, to the best of our ability, provided that work such as is usually provided by professionals is not expected. Stamped addressed envelopes should be enclosed. “Puzzle horoscopes” are always interesting to us, and would probably also interest other readers.

As regards the vexed question of dignities and debilities, it would seem that such conditions do powerfully modify aspects, but I have never heard the theory that it is the applying planet only that counts in this respect, and this seems a little illogical, though it may well be the applicant body is the more important of the two.

The ancients taught that a planet was good in its positive sign

and bad in its negative; thus Mars in Aries is brave and enterprising, but Mars in Scorpio is bloodthirsty, treacherous, etc. This, of course, does not hold for the average person, but there is a good deal of underlying truth in it. Thus in my *Astrology of Accidents* I have shown that Saturn in Capricorn is very prone to cause accidents, and so too Jupiter in Pisces.

Saturn in Cancer is apt to be mean and Saturn in Leo either licentious or ascetic, but rarely balanced. But Saturn in Libra is also frequently unhappy in marriage and other forms of partnership, and Saturn in Aquarius is not always fortunate in its friends and associates.

It would seem that we must study each contact *in itself*, and not try to make hard and fast rules. Astrology is an image of Life, and can no more be reduced to precise terms than can life. One can no more say what exactly is a good aspect than one can say what exactly is a good poem or a good song. But we can affirm certain general principles of Life and of astrology and of Poetry. These, however, must be (so far as we can) understood and not merely applied by rule of thumb.

A practical method of testing whether a given aspect is good or bad in an actual as distinct from a theoretical sense is to note the action of directions between the two bodies in question. Here I may be forgiven for being personal. I have Moon exalted in Taurus and applying to the squares of Mercury and the Sun, and I can certainly say that *all* directions between the Moon and these two bodies tend to work inharmoniously, whether they are squares or trines. Hence I am quite convinced that the exaltation of the Moon does not prevent its squares from being difficult. This is not to say that they are as discordant as they would be were the Moon not dignified.

C. E. O. C.

FIXED STARS AND HOUSE-DIVISION

From GEORGE H. BAILEY.

The conclusions drawn by M. Léon Lasson in his book (reviewed last quarter) concerning the effect of the fixed stars are tremendously significant. He shows that conjunctions of planets with violent stars are more effective when in the same circle of position than when in the same zodiacal longitude, and by so doing he not only proves the potency of stellar influence, but also the importance of house position. The circles of position mentioned are nothing more than house circles, akin to the cusps, and the conjunctions are therefore simply conjunctions *in mundo*, the two bodies concerned being exactly the same distance from the adjacent house cusp, measured in degrees of arc on the plane of the prime vertical.

More important still, perhaps, this evidence definitely gives a lead in the problem of house-division, for although M. Lasson

mentions Regiomontanus, the circles of house position are equally correct for *any* system whose cusps converge to the north and south points of the horizon, and consequently the given facts prove Campanus just as much as Regiomontanus. Moreover, at the same time they effectively dispose of Placidus in addition to all those systems whose cusps run either to the poles of the equator or to the poles of the ecliptic.

The need for an English translation of M. Lasson's book is an urgent one, although without the inclusion of tables to enable the poles of the planets to be readily found, those who prefer to abstain from mathematical gymnastics will not be able to put it to much use, and on their behalf one would like to know more of the excellent tables by Gouchon and Reverchon to which M. Lasson refers.

A further drawback to a comprehensive investigation of the subject is the omission of quite a number of stars from the catalogue given.

STALIN'S BIRTH DATE

From MONKTON FARLEIGH.

As there is still a point not touched upon in this correspondence, I would like to ask Miss Matthews (also Messrs. Clancy, Tucker, and Bray) when Christmas Eve is (or was) celebrated in Russia. If it occurs on December 24th, and Comrade Stalin was born eight days after, the date of his birthday must be January 1, 1880. As, however, at this period Russia was twelve days behind our calendar, our equivalent date is January 13, 1880.

SOME NOTES ON TRANSITS

By C. E. O. CARTER

ONE may assume, I think, that virtually all astrologers believe in the efficacy of transits, even if some place much more stress on their importance than do others. In our time Cyril Fagan has done much to bring their value before the general body of students, and has shown that there is much more in the subject than is commonly believed.

Perhaps some of the very mathematical object to transits because they are so simple! A beginner can "spot" them at sight from the ephemeris, and there are really no difficulties about them at all.

However, even in dealing with transits, one must never lose

sight of the radical map and must recall that, because a specific transit causes *X* in one map, it does not follow that it will not cause *Y* in another, whilst in a third case it may, for perfectly good reasons, do little or nothing.¹

One point often overlooked is that of *latitude*. If the planet in transit differs greatly in latitude from the radical planet over which it is passing, then one may legitimately expect but a slight result. Solar eclipses, which are transits of the Moon over the Sun without latitudinal difference, are far more potent than ordinary lunations; hence one may deduce the likelihood of similar principles being operative when a planet passes over a radical place.

Another point of note is that when a planet, owing to retrograde motion, passes over a point in the radix three or more times, it is usually the last transit which "delivers the goods." Often a long-drawn-out condition comes to its conclusion at that time, either for good or ill.

We suggest the following classification of transits:—

1. Simple transits of minor planets. These, with the exception, at times, of Mars, are unimportant, indicating as a rule trivial and ephemeral matters.

2. Simple transits of majors, which are often important, but never, by themselves, epoch-making.

3. Compound transits or simultaneous transits of two or more bodies. These arise when two or more bodies simultaneously aspect a point in the radix, and they vary in importance according to the natures of the aspecting bodies and the degree of exactitude. Thus if two planets form a trine in the heavens and the point at which the trine is formed is itself very nearly in exact aspect to a radical point, then the results may be very potent.

A personal example: I became engaged on November 22, 1912. At the time the Sun was about $0^{\circ} 10'$, in sextile to Uranus in $0^{\circ} 18'$. Saturn was in $0^{\circ} 39'$ retrograde. Thus all three were playing powerfully on my radical Mars, ruling the 7th, in $0^{\circ} 26'$. The actual trine of Saturn and Uranus was formed on the 25th, in $0^{\circ} 26'$ of their respective signs, *exactly* aspecting my Mars. It may be observed that on the 24th Mars was trine Neptune in $25^{\circ} 50'$ of the respective signs, only $14'$ from the aspect of my radical Venus. On the 22nd the Moon was also trine Mercury, involving my radical Jupiter.

I trust this example will illustrate what I mean by simultaneous transits.

¹ A *weak benefic* will often do little or nothing.

An eclipse is, of course, a simultaneous transit, that is to say, if it affects a specific map at all. So, too, are ordinary lunations, but, because both bodies are swift of motion, the latter are not usually important, unless they aspect a powerful radical configuration very closely.

Various other considerations will suggest themselves to every intelligent student. Thus it is probable that the most marked events—though not necessarily the most important—are produced by oppositions and conjunctions.

The first example that occurs to me, in my own history, is the opening days of June 1917, when I first went into action. Mercury, Mars, and Jupiter are in conjunction almost right on my radical Neptune, whilst—a lesser point, but worth mentioning—Venus, Saturn, and Uranus are also within orbs of aspect of the same group.

The detection of simultaneous transits is not a difficult matter. It is only necessary to glance down the list of the month's aspects in the ephemeris, note roughly in which degree they fall, and see if that degree, in any sign, is radically important. As the most important simultaneous transits commonly involve at least one major planet, the point of aspect can usually be seen within a minute of the ecliptic at a glance.

Thus, in the present month of June 1937, the first important contact is $\odot \Pi \square \Psi \text{M}$, which, as we can see at a glance, falls in $16^{\circ} 11'$, impinging on my radical ascendant and Saturn within about a degree. Neptune is in Virgo on the cusp of the 12th (Camp.) in my map, and gives the key-note—the necessity of daily visits for some weeks to a hospital to visit a son (\odot) injured by a fall (h). Of course the eclipse on the next day greatly aggravated the stellar influence of the period—a square of the Sun to Neptune, within a degree or so of radical positions, would not usually produce serious results. If it did, life would in truth be hectic!

In all aspectual matters *closeness* is of primary importance.

A further point is the *stationary position of planets*. Planets that become stationary on a sensitive point often produce or portend important events that follow at no great distance of time.

Picking at random, I may mention Cases Nos. 1 and 3 in *The Astrology of Accidents*, Case No. 2 being omitted as of a much less serious nature.

Case No. 1 is that of a girl born 7 a.m., December 13, 1926, 51 N., 2 W. Died of burns August 12, 1930.

On July 21st prior to death Uranus was stationary in $15\frac{1}{2}$ Aries, exactly square radical Pluto $15\frac{1}{2}$ Cancer, in 8th.

Case No. 3 is that of a boy born at Manchester, September 2, 1901, at 1.30 p.m. Drowned 12.8.1907.

On 10.8.1907 Mars was stationary in 7° Capricorn conjunction Saturn radical and opposite cusp 8th. Uranus in the heavens was not far from conjunction Saturn radical also.

Without wishing to claim too much, I think I can postulate that there is even more in transits than is commonly supposed, and that they constitute an interesting and fertile field of inquiry.

REVIEWS

Comets and the Sun, by P. J. HARWOOD. Published by the Author at "Corona," Ovingdean, Brighton. Price 9d. net.

In this booklet Mr. Harwood presents a new theory to account for the puzzling behaviour of comets when passing round the sun, based on the findings arrived at in his larger work *A Theory of the Solar System*. He likens the sun to an immense electrical machine functioning in the high vacuum of space and consequently able to produce somewhat similar phenomena (but on a much larger scale) to that obtained in a Crookes's vacuum tube, in the laboratory. Amongst other things, Mr. Harwood suggests that this accounts for the peculiar fact of cometary tails always pointing away from the sun, the planets being safeguarded from such conditions by virtue of their orbits lying close to the solar equatorial plane, instead of at a wide angle to it as in the case of most comets.

If this theory, so lucidly put forward, be a true one, its implications will deserve the close attention of astrologers as well as astronomers.

G. V.

Do the Stars Compel? by CHARLES E. O. CARTER. Published by The Harrogate Convention, H. Hosking Burnell, Pool Bank, near Leeds. Price 6d., 7d. post free

In this, the first of the "Alan Leo" series of lectures to be given at the Harrogate Conventions, Mr. Carter gives a new presentation of an old subject. From a brief commendation of Alan Leo and his work he turns to the well-known slogans associated with that Master-Astrologer—"the stars incline, they do not compel" and "the wise man rules his stars, the fool obeys them"—and analyses the inter-relationships existing between the heavenly bodies and ourselves, differentiating between those parts of our consciousness which are susceptible to and those which are immune from stellar influence. If by desire we are bound, Reason, linked with the

intuitions of Goodness and Beauty, will set us free, says Mr. Carter, no matter what pressure may be put upon us by fate in the guise of circumstance.

A small book, but of great value.

G. VJ.

"Astrological Lodge" Badge, 1s. 7½d. post free, from Mrs. Parkes, "Southlands," Longdown Lane North, Epsom, Surrey.

A dainty creation in blue, white, and silver enamel with the letter "A" as foundation, fronted by a seven-pointed star. Unlike some "arty" badges, it is quite wearable, and is just the thing to sport on Monday evenings, so as to be with the Lodge in spirit, if not in person.

G. VJ.

Electional Astrology, by VIVIAN E. ROBSON, B.Sc. J. B. Lippincott Company, London and Philadelphia. Price 5s. net.

New books by Mr. Robson have come to be regarded as welcome events in the astrological world, and the present work is likely to prove no exception; indeed, the fact of its being solely devoted to a strictly utilitarian branch of astrology rather neglected in recent years is likely to enhance the warmth of its reception.

The purpose of electional astrology is to determine the most suitable time for starting any new undertaking, no matter what, and in this book Mr. Robson contrives to include an immense assortment of pursuits in which the human race is interested, from removing superfluous hair or corns to the building of cities, all conveniently grouped in sections according to their kind. Based on ancient rules and amplified to include modern interpretations, the directions given are particularly lucid, and should enable the veriest tyro to try his hand with confidence, provided he is able to cast a horoscope.

The Moon is an extremely important factor in elections, and two chapters are specially devoted to her attributes, positions, aspects, and mansions. Planetary hours also form the subject of a separate chapter, and a useful glossary of astrological terms is given as an appendix.

G. VJ.

Transcendental Astrology, by A. G. S. NORRIS. Rider & Co., London, E.C.4. Price 15s. net.

It takes all sorts of people to make a world, and this applies as much to the world of astrology as to any other. For this reason it is probable some astrological students will derive much inspiration from this book, while others will find themselves heavily oppressed by the mass of verbiage with which the whole book is saturated. Words, words, words pour out in vast cataracts, drenching the subject-matter, and fit to drown the wits of the ordinary reader.

The main purpose of the book seems to be the blending of numerology with a theosophic and Rosicrucian conception of astrology, obviously written with a sincere desire towards spiritualising the subject. The meanings of the symbols of the planets and their numerical values are gone into with a wealth of detail, as also are their relationships with the seven interpenetrating worlds of the different grades of spirit and matter, the days of the week, the calendar, the alphabet, and, of course, that strange creature we know as Man. The work is illustrated by a number of beautiful diagrams, some of which, however, seem rather far-fetched in their implications. Rules are given for what the author terms "scientific" delineation (a pity "scientific" should be so overworked a word in astrology nowadays), followed by a lengthy example, and (shades of Wemyss!) we are also introduced to a new outer planet, Athene, due to be discovered in 1938.

Mr. Norris offers no explanation, but it would be interesting to learn how Pythagoras managed to associate numbers with the English alphabet, and how our purely arbitrary calendar came to be linked up with planetary vibrations. He avers that some of the matter was received inspirationally, and he also states that "Beings in far higher stages of evolution have guided the work," yet, on another page, he suggests his task "would be well repaid if but one leading astronomer is induced to take an interest in the application of the numbers of the planets." Just one leading astronomer! Such bathos calls for no further comment.

G. V.

PLANETOSOPHY. TABLES. HALF-CENTURY EPHEMERIS 1886/1935

MOON'S LONG. EVERY DAY.

DECLINATION ALTERNATE DAYS.

TIMES OF ALL NEW AND FULL MOONS.

PERIGEEES, APOGEEES AND ECLIPSES.

HOUSES FOR ALL LAT^s 10°-60°

SUNDRY TABLES, DATA AND NOTES.

300 pages, 7" × 4½". Thin. Flex.

♂ ♀ ♃ ♄ ♅ ♆

EVERY TENTH DAY.

MERCURY, SUN, VENUS,
EVERY FIFTH DAY.

GAZETTEER, STANDARD
TIMES, SUN RISE & SET.

ZODIAC DEG^s, R.A. & DECⁿ.

TEN SHILLINGS NET.

COUPON

To be used with the "Answers to Questions" Department (see page 113).

Questions should be sent, with this coupon, to "V. C.," c/o "ASTROLOGY," 59 Victoria Drive, London, S.W.19.

WORKS BY B. V. RAMAN

Editor, ASTROLOGICAL MAGAZINE.

1. **A MANUAL OF HINDU ASTROLOGY.**—The finest book ever published, giving a clear and concise account of the essential principles of Astrology; an excellent guide for the beginner and the advanced. Printed on antique paper and cloth bound: **Rs. 4 or 8s. or \$2.**
2. **A TEXTBOOK OF HINDU ASTROLOGY.**—Contains the cream of Hindu Predictive Astrology; all branches of astrology treated in a graduated form; with the aid of this book one can clearly study one's past, present, and future with accuracy; in typescript and cloth bound: **Rs. 18 or 37s. or \$12.**
4. **GRAHA AND BHAVA BALAS.**—A unique treatise for measuring strengths of planets and houses numerically; an excellent aid to predictive astrology; typescript and cloth bound: **Rs. 12 or 25s. or \$8.**
3. **VARSHAPHAL OR ANNUAL READING.**—Gives easy methods for scientific and accurate deciphering of annual results; typescript and cloth bound: **Rs. 10 or 20s. or \$6.**
5. **THE ASTROLOGICAL MAGAZINE** (Founded 1895 by B. Suryanarain Row).—Edited by Dr. B. V. Raman; published every July, October, January, and April; containing regular features on Astrology, Astronomy, Palmistry, Medicine in relation to Astrology, Phenology, Yoga, Weather Cycles, Financial Astrology, etc; Annual subscription, **Rs. 3.6.0**, Indian; Foreign **6s. 6d.**; American **\$2.20**. Single copy **As. 12 or 1s. 6d. or 60c.** No specimen sent.

EXCHANGES INVITED FROM OTHER PERIODICALS.—*Horoscopic work undertaken on payment of reasonable fees.*

Apply:

B. V. RAMAN,

Editor, THE ASTROLOGICAL MAGAZINE,
BANGALORE, INDIA.

P.O. Malleswaram.

EDGAR BRAY ASTROLOGICAL CONSULTANT

Undertakes all kinds of astrological work

Write for terms, stating requirements, to—

EDGAR BRAY, 28 Talbot Road, Wembley, Middlesex

SOME OBJECTIONS TO ASTROLOGY STATED AND ANSWERED

and I am offering this little work, which consists of 24 pages and cover, $5\frac{1}{2}'' \times 4''$, at $2\frac{1}{2}d.$ a copy post free, which is cost price.

It is expected that astrological institutions and societies will find this booklet of great use for distribution among inquirers and also for discussion in study-groups.

All copies should be ordered *direct from me*, and U.S.A. postage stamps (5 cents) will be accepted in payment, but *not* coins.

CHARLES E. O. CARTER,

59, Victoria Drive,

London, S.W.19.